

THE VALE OF  
GLAMORGAN COUNCIL  
TOWN AND COUNTRY PLANNING ACT 1990  
**APPROVED**  
SUBJECT TO COMPLIANCE WITH CONDITIONS (IF ANY)

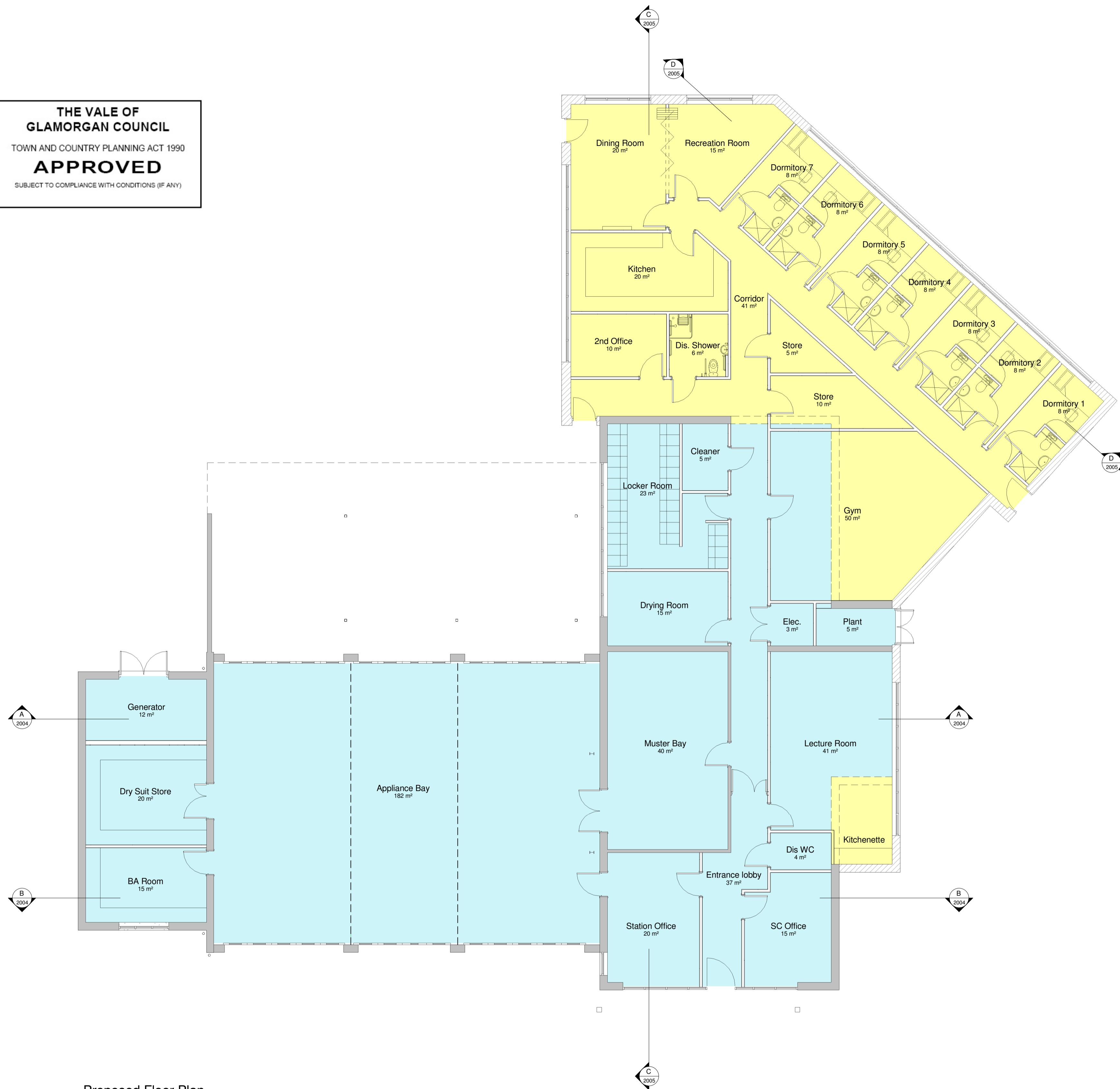

Proposed Floor Plan  
1 : 100

ALL DIMENSIONS TO BE CHECKED ON SITE.  
DO NOT SCALE THIS DRAWING.  
ALL DISCREPANCIES TO BE REPORTED IMMEDIATELY.  
© COPYRIGHT

NOTES:

- Existing Refurb Area  
Area = 465.5m<sup>2</sup>
  - Proposed New Build Area  
Area = 260.3m<sup>2</sup>
- Total Floor Area = 725.8m<sup>2</sup>

No.	Revision Description	Date	By
-----	----------------------	------	----

CLIENT  
SOUTH WALES FIRE &  
RESCUE SERVICE

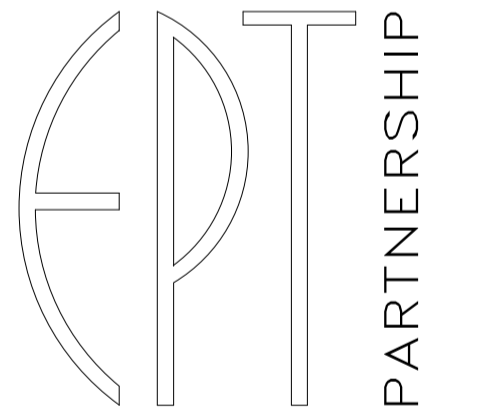

ARCHITECTS  
PENSEIRI  
TY CEFN , RECTORY ROAD  
CANTON , CARDIFF CF5 1QL  
TEL : 029 20 344 966  
FAX : 029 20 344 942  
epf@eptpartnership.com  
www.eptpartnership.com

PROJECT  
PENARTH FIRE STATION

TITLE  
PROPOSED FLOOR PLAN

Drawn : JM Date : 14/08/14 Checked : MP

Scale : Original sheet size :  
1 : 100 A1

- DRAWING STATUS
- Design Development
  - Tender
  - Design Development Pre-Construction
  - Construction
  - Record

Project No Dwg No Revision  
10323 2001