

THE VALE OF  
GLAMORGAN COUNCIL  
TOWN AND COUNTRY PLANNING ACT 1990  
**APPROVED**  
SUBJECT TO COMPLIANCE WITH CONDITIONS (IF ANY)

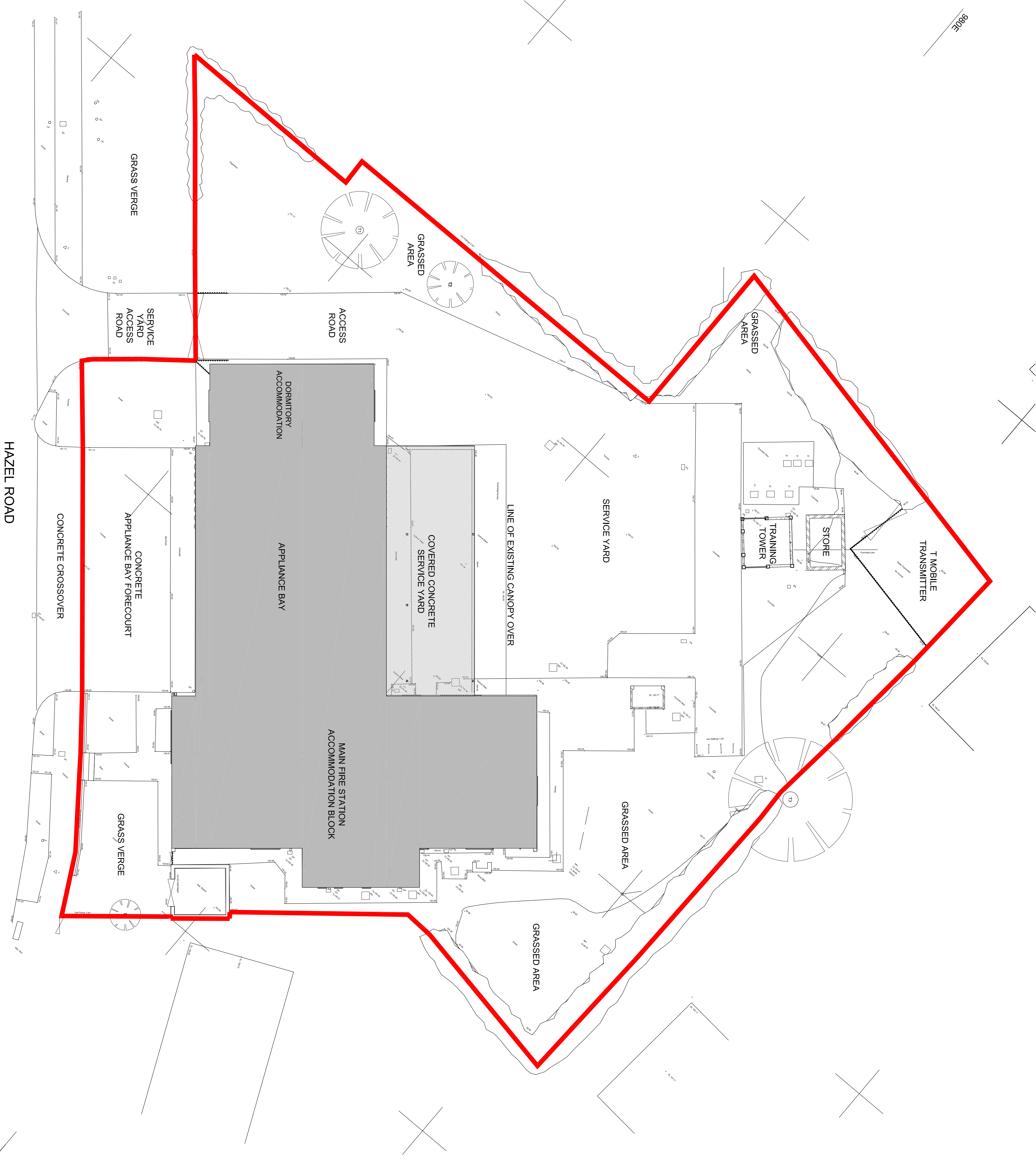

ALL DIMENSIONS TO BE CHECKED ON SITE  
DO NOT SCALE THIS DRAWING.  
ALL DISCREPANCIES TO BE REPORTED IMMEDIATELY.  
© SEP 1999/01

No.	Revision Description	Date	By

CLIENT  
SOUTH WALES FIRE & RESCUE SERVICE

**EPIT PARTNERSHIP**  
ARCHITECTS  
PENSAIRI  
TY CEFN, RECTORY ROAD  
CANTON, CARDIFF CF5 10L  
TEL : 029 20 344 966  
FAX : 029 20 344 942  
epi@epipartnership.com  
www.epipartnership.com

PROJECT  
PENARTH FIRE STATION

TITLE  
EXISTING SITE PLAN

Drawn : JM Date : 15/08/14 Checked : JMP  
Scale : Original sheet size :  
1:100 @A1 & 1:200 @A3

- DRAWING STATUS
- Design Development
  - Tender
  - Design Development-Pre-Construction
  - Construction
  - Record

Project No      Dwg No      Revision  
**10323 1000**