

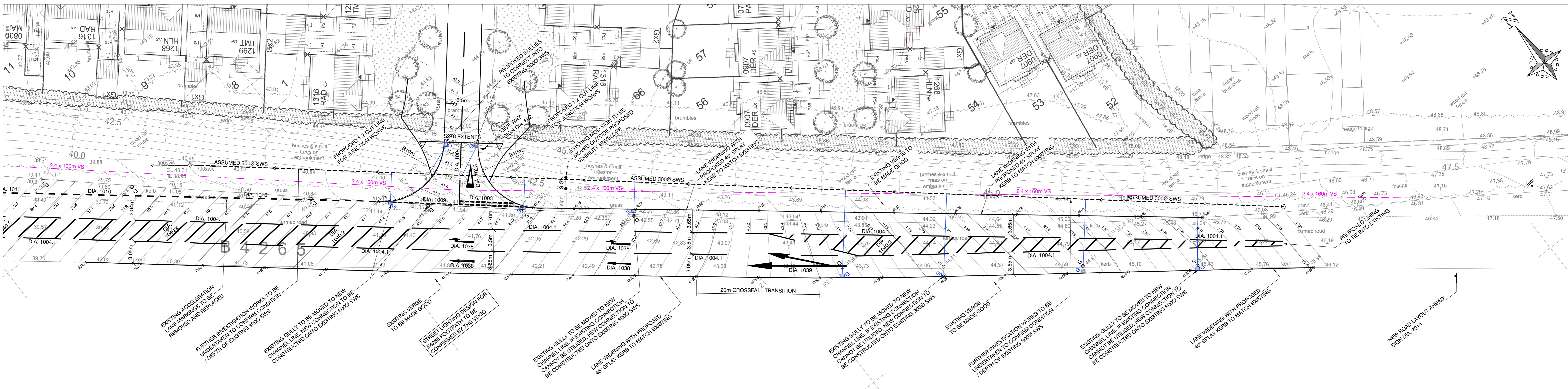

S278 GA - NORTH-WEST SECTION OF SITE
SCALE 1:250



S278 GA - SOUTH-EAST SECTION OF SITE
SCALE 1:250

- NOTES
1. ALL LEVELS AND DIMENSIONS SHOWN IN METRES UNLESS NOTED OTHERWISE.
 2. REFER TO THE TRAFFIC SIGNS REGULATIONS AND GENERAL DIRECTIONS - 2002 (TSRGD).
 3. ALL HIGHWAY WORKS TO BE CONSTRUCTED IN ACCORDANCE WITH THE CURRENT HIGHWAY AUTHORITY DESIGN GUIDE AND SPECIFICATION.
 4. ALL HIGHWAY WORKS ARE TO BE THE SUBJECT OF A SECTION 278 AGREEMENT OF THE HIGHWAY ACT 1980.
 5. THIS DRAWING IS COPYRIGHT. ITS USE OR REPRODUCTION WITHOUT WRITTEN PERMISSION OF QUADCONSULT LTD IS PROHIBITED.
 6. NO RESPONSIBILITY WILL BE TAKEN FOR ANY CONSTRUCTION WORK UNDERTAKEN PRIOR TO RECEIPT OF TECHNICAL APPROVALS FOR THE INTENDED CONSTRUCTION, OR WHEN WORK IS NOT EXECUTED STRICTLY IN ACCORDANCE WITH THE DRAWINGS.
 7. EXISTING WHITE LINES WITHIN EXTENTS OF WORKS TO BE BURNT OFF AND PREPARED FOR NEW WHITE LINING APPLICATION.

PRELIMINARY

Rev	Date	Description	By
01	20/11/2017	TOPOGRAPHICAL SURVEY (REVISED)	ACV

Dimensions to be verified on site. This drawing should not be used. Use figured dimensions only. Any discrepancies should be referred to the Engineer prior to work being put in hand. This drawing is copyright.

QuadConsult Limited
Cannock Chase, Village Way
Cannock, Staffordshire, UK
ST10 2NE
01827 9644
info@quadconsult.co.uk
www.quadconsult.co.uk

QuadConsult
ENGINEERS IN PARTNERSHIP
Consulting Civil & Structural Engineers

BARRATT
HIGHWAYS
find the way

Land North of B4265, Boverton

SECTION 278 WORKS
GENERAL ARRANGEMENT

SECTION 278

Design	Drawn	Checked	Date	Scale
ACV	ACV	ACV	NOV 2016	1:250

Project No	Drawing No	Revision
14009	C-200	01