



**Footpath Diversion Key**

-  Existing Public Right of Way
-  Indicative PRoW Diversion

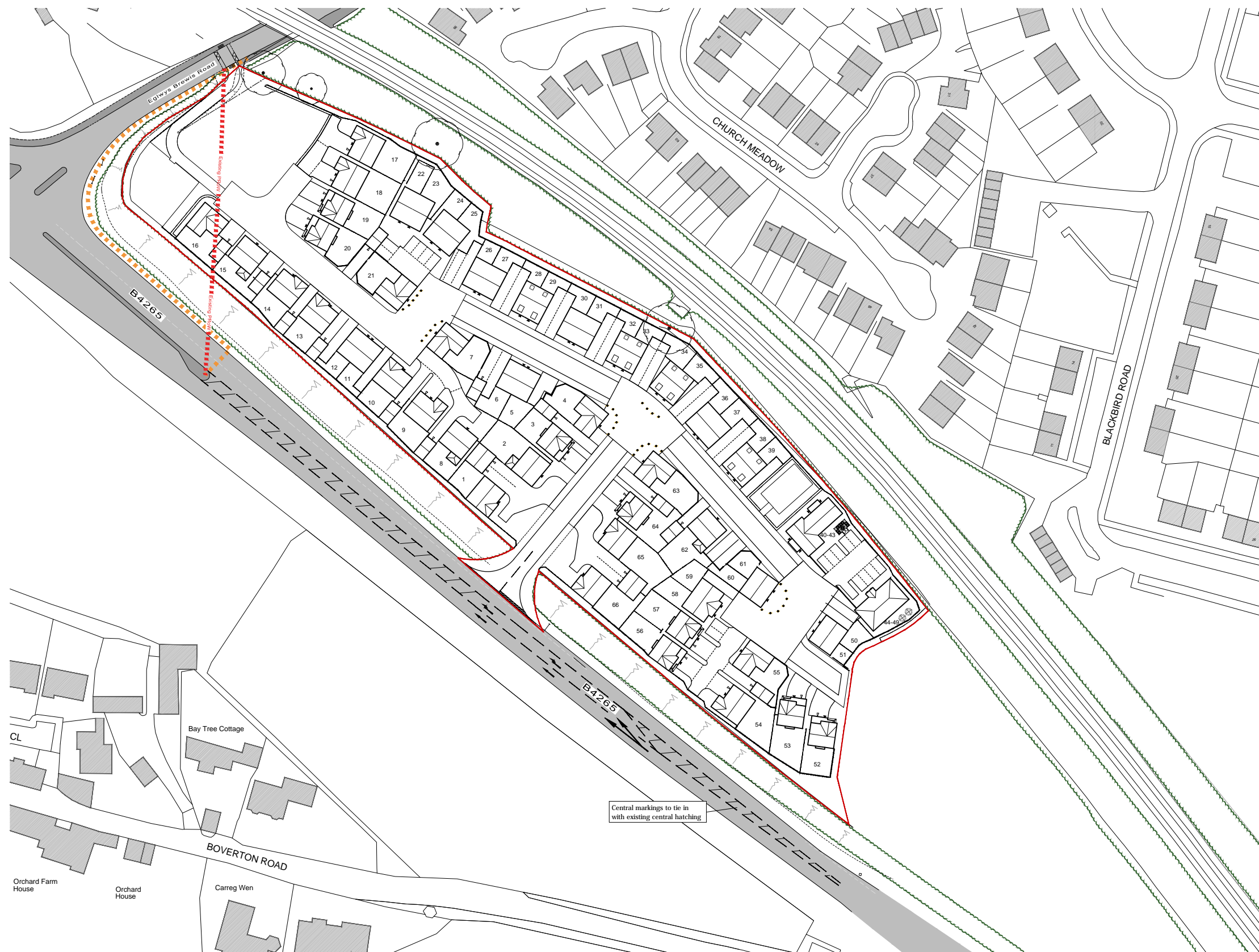

E:	Layout updated	10.02.17
D:	Layout updated	20.12.16
C:	Layout updated	25.11.16
B:	House types at plots 28-29 & 30/31 switched. Paved squares with bollards added.	30.09.16
A:	Layout updated	09.09.16
REV.	DESCRIPTION	DATE

CLIENT  
**Barratt Homes South Wales**

JOB TITLE  
**Land North of B4265, Boverton**

DRAWING TITLE  
**Public Right of Way Diversion Plan**

SCALE @ A3	DATE	DRAWN BY
1:1250	June '16	RW
JOB NO.	DRAWING NO.	REVISION
1363	PRW-03	E



10 Gold Tops  
 Newport  
 NP20 4PH

t. 01633 844970  
 e. info@hammond-ltd.co.uk

[www.hammond-ltd.co.uk](http://www.hammond-ltd.co.uk)

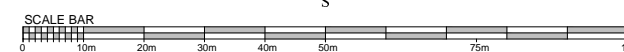
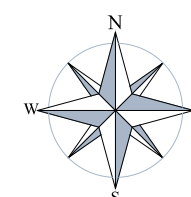

© Hammond Architectural Limited 2017  
 Figured dimensions must be taken in preference to scaled dimensions and any discrepancies are to be referred to Hammond Architectural Ltd. Contractors, subcontractors and suppliers must verify all dimensions on site before commencing any work or making any workshop drawings.