

Natural play bund, boulders and stepping stone log cross section elevations L.A.P 1

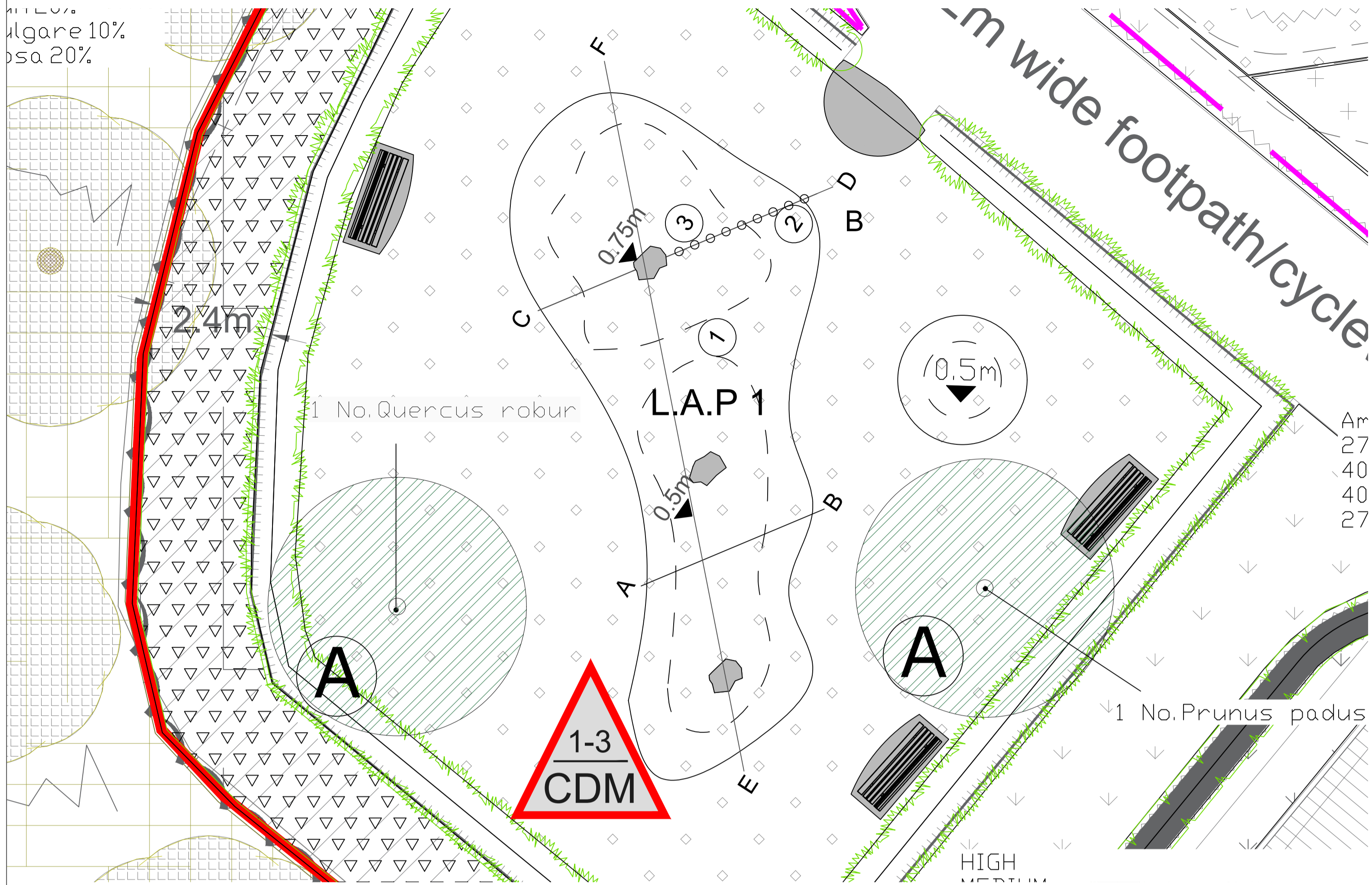

Natural play bund, boulders and stepping stone log cross section elevations L.A.P 2

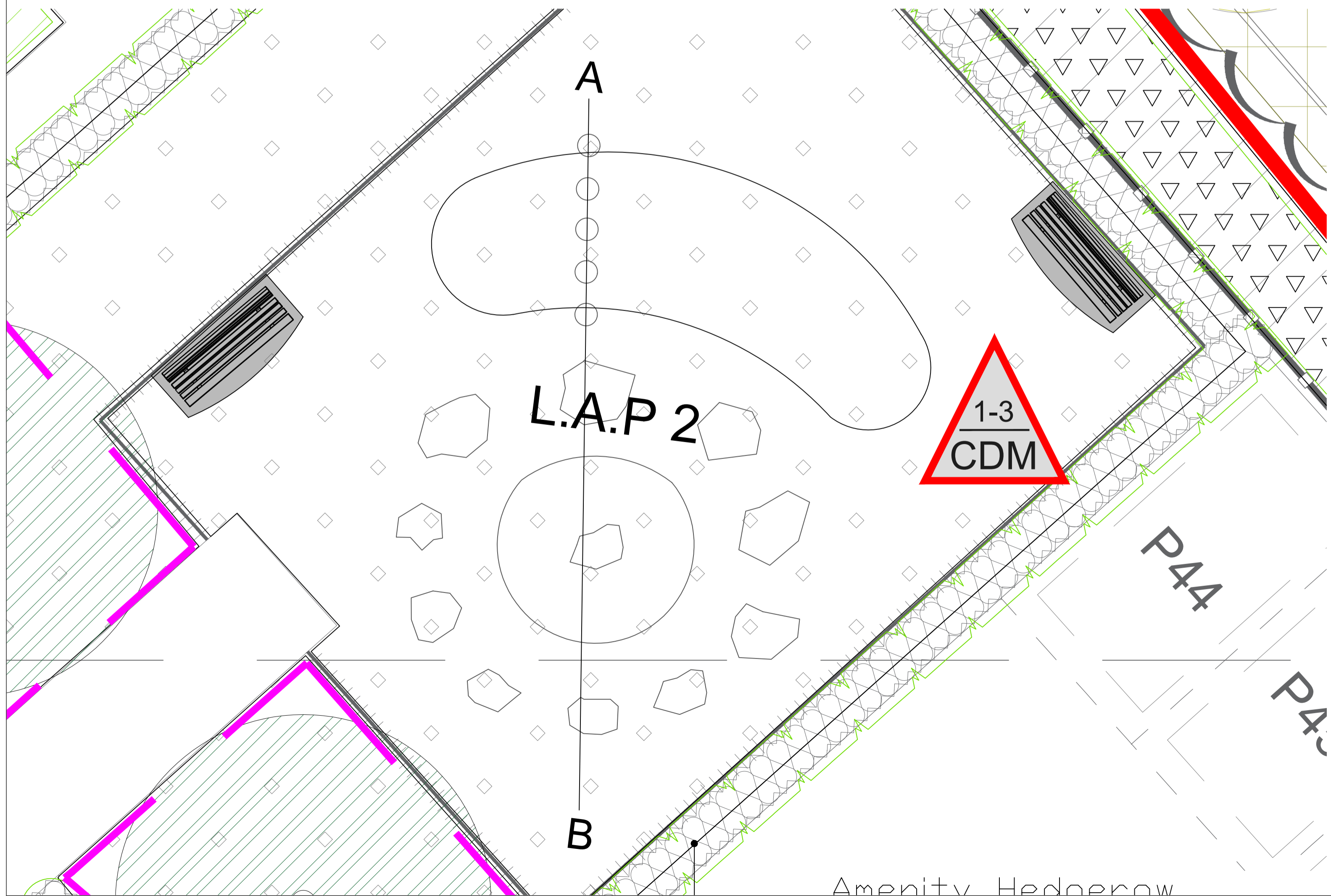

L.A.P Design Details

1. Natural Theme Play

The Natural Theme play aspect of the L.A.P will consist of gentle banks and undulations giving rise to an interesting and imaginative landscape setting. Stepping pads and natural boulders add tactile features enhancing the experience of play whilst implying key routes and trails within the space.

2. Stepping Stone Logs or similar approved

Supplier: Playdale Playgrounds
Dimensions: 0.2x0.2x0.6
To be installed and maintained as per manufacturers recommendations



3. Natural Quarry Stone Boulders or similar approved

Supplier: Specialist Aggregates Ltd.
Dimension: 1200x1000x500mm.
Net weight: Approximately 1.5 tons. To be installed and maintained as per Landscape Architects and Engineers recommendations.

4. Bench with Backrest, Pine or similar approved

Supplier: Kompan
Dimension: 1800x580mm
Weight: n/a
To be installed and maintained as per manufacturers recommendations

Natural play bund, boulders and stepping stone log cross section elevations L.A.P 1

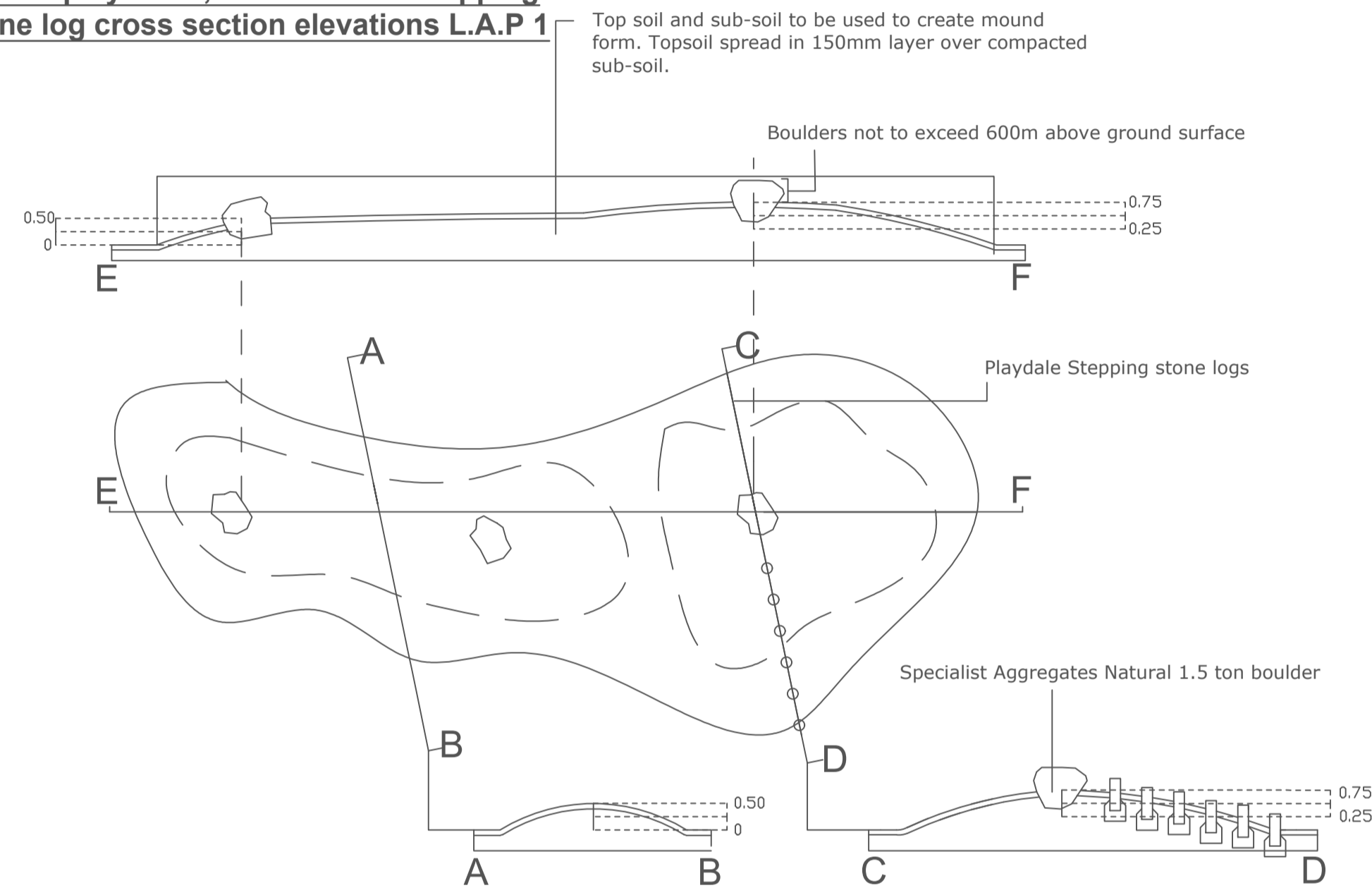

Natural play bund, boulders and stepping stone log cross section elevations L.A.P 2

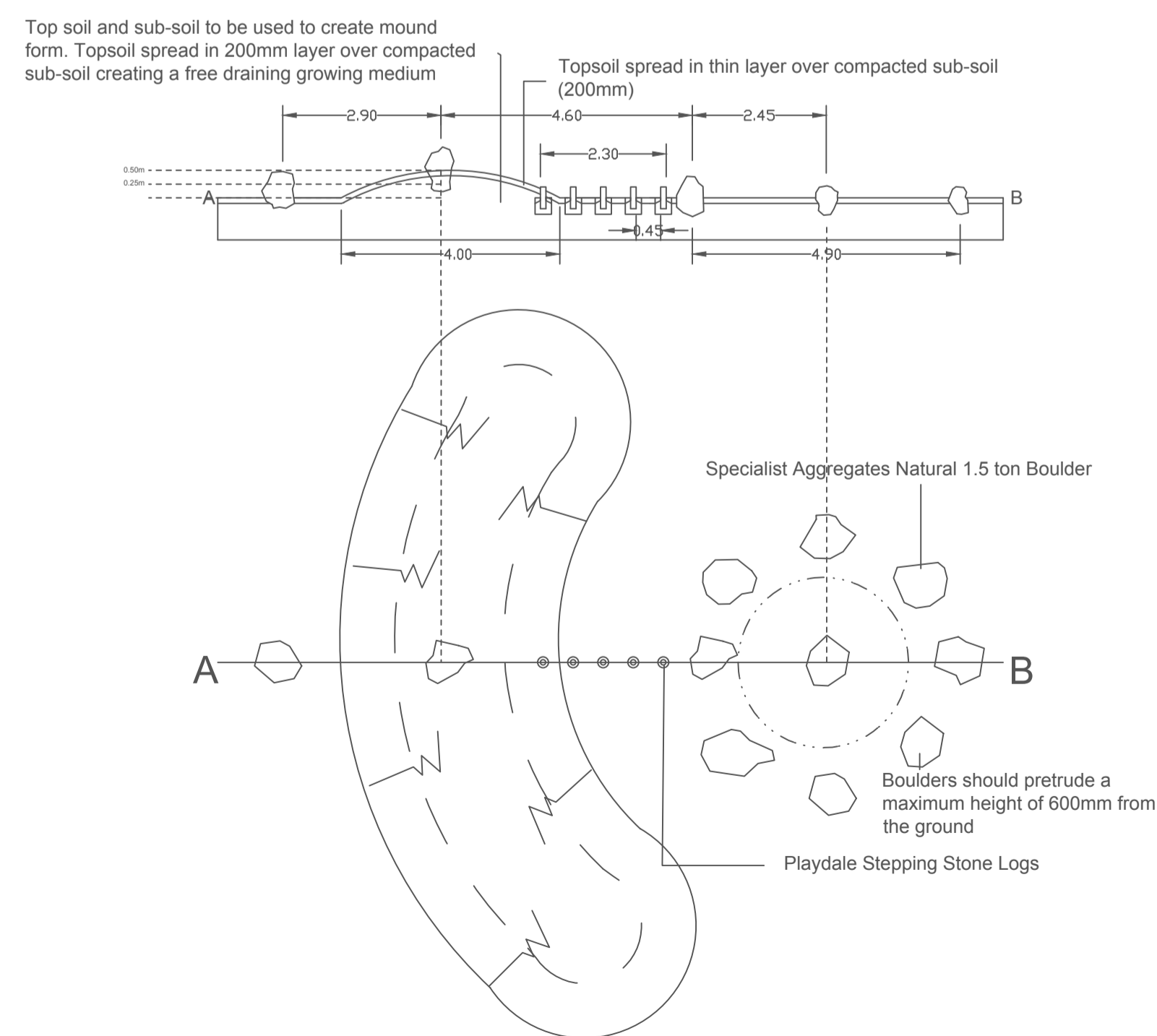

	Site Boundary
	Retained Trees
	Proposed Trees
	Tree Pit Specification Type <small>Refer to eq3209_e6 for specification detail</small>
	Native Hedgerow
	Ornamental/ Native Hedge
	Native Whip Structure Planting
	Specimen Shrub
	Amenity Plot Planting
	Amenity Turf
	Wildflower Meadow <small>EM7 - Meadow Mixture for Sandy Soils</small>
	Wear Tolerant Turf Mixture <small>EG22 - Wear Tolerant Turf grass Mixture</small>
	Existing Vegetation
	Decorative Aggregate Gravel <small>Plum Slate Chippings</small>
	Root Barrier System
	Concrete Pads
	Bench Unit

CDM Notes
A risk assessment has been carried out for the design of the LAP. Residual risks identified following completion of the design process are listed below.

- Residual Risks**
1. Timber posts or stepping stones becoming loose in the ground.
 2. Tops of timber posts becoming slippery due to any build up of moss/algal growth.
 3. Erosion of embankment exposing jagged concrete foundations.

- Control Measures**
1. Timber posts and stepping stones to be checked monthly to ensure they are securely rooted in the ground. Any loose posts or stones to be re-seated or replaced.
 2. Tops of timber posts to be kept free of moss/algal growth through pressure washing.
 3. Embankment and grass to be inspected monthly with soil replaced and grass replaced if necessary.

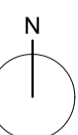

edp
THE ENVIRONMENTAL DIMENSION PARTNERSHIP
Tilke Barn, Barnsley Park Estate, Barnsley, Gloucestershire, GL7 5EG t 01285 748427 f 01285 748448 e info@edp-uk.co.uk www.edp-uk.co.uk

client	Barratt Homes		
project title	Llantwit Major Bypass, Boverton		
drawing title	Detailed Soft Landscape - L.A.P Construction Details and Street Furniture Sheet 5 of 5		
date	21 DECEMBER 2016	drawn by	DB
drawing number	EDP070205	checked	KH
scale	Not to scale	checked	JW