

THE VALE OF GLAMORGAN COUNCIL
 TOWN AND COUNTRY PLANNING ACT 1990
APPROVED
 SUBJECT TO COMPLIANCE WITH CONDITIONS (IF ANY)

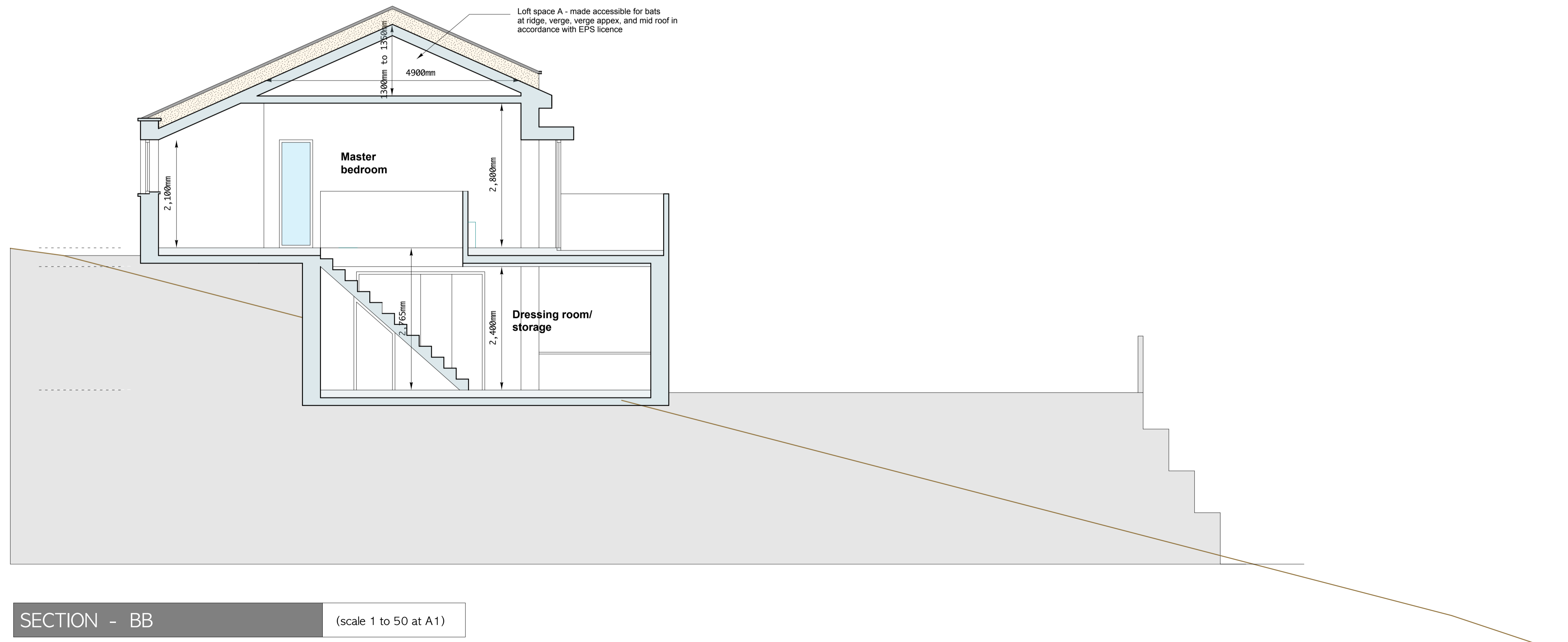
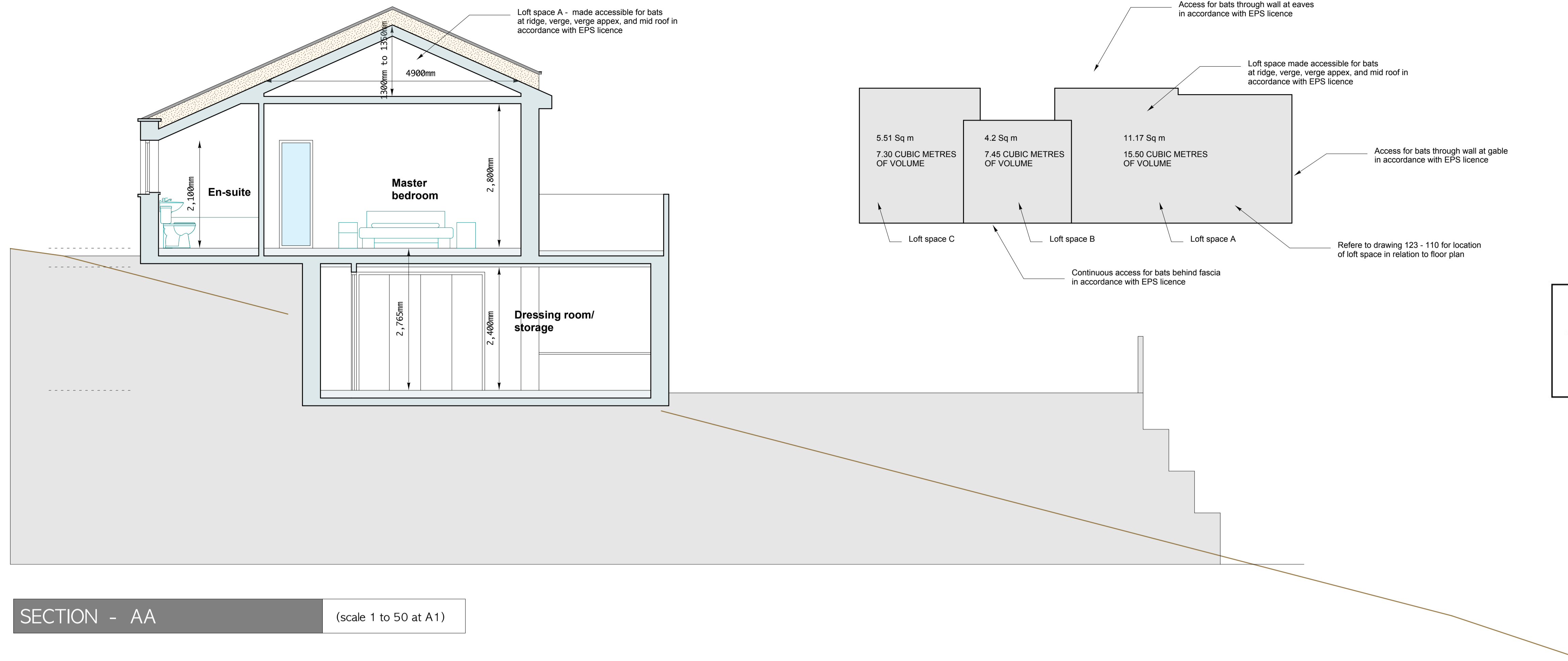

Do not scale, use figured dimensions only. Dimensions to be checked on site and any discrepancies reported to the Architect immediately. This drawing is copyright.

Revision Date Comments

Rev A - 29 July 2014 - Various design changes
 Rev B - 29 October 2014 - Information on Bat mitigation measures added

Reuben Evans ARCHITECT BSc BA Arch

Telephone: 01446 791154
 Mobile: 07890 185884
 Email: re@reubenevans.co.uk

Project: Proposed two storey dwelling at Little Pen Onn, Llancarfan, Barry, CF62 3AG

Client: Dr Philip Akin and Charlotte Eckhardt

Drawing: Proposed SECTIONS - AA and BB

Date: July 2014 Scale: 1 to 50 at A1 Drawing No: 132 - 114 REV B

PLANNING ISSUE