

THE VALE OF
GLAMORGAN COUNCIL
TOWN AND COUNTRY PLANNING ACT 1990
APPROVED
SUBJECT TO COMPLIANCE WITH CONDITIONS (IF ANY)

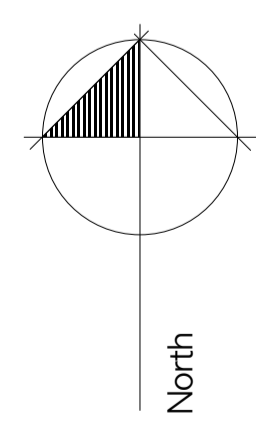
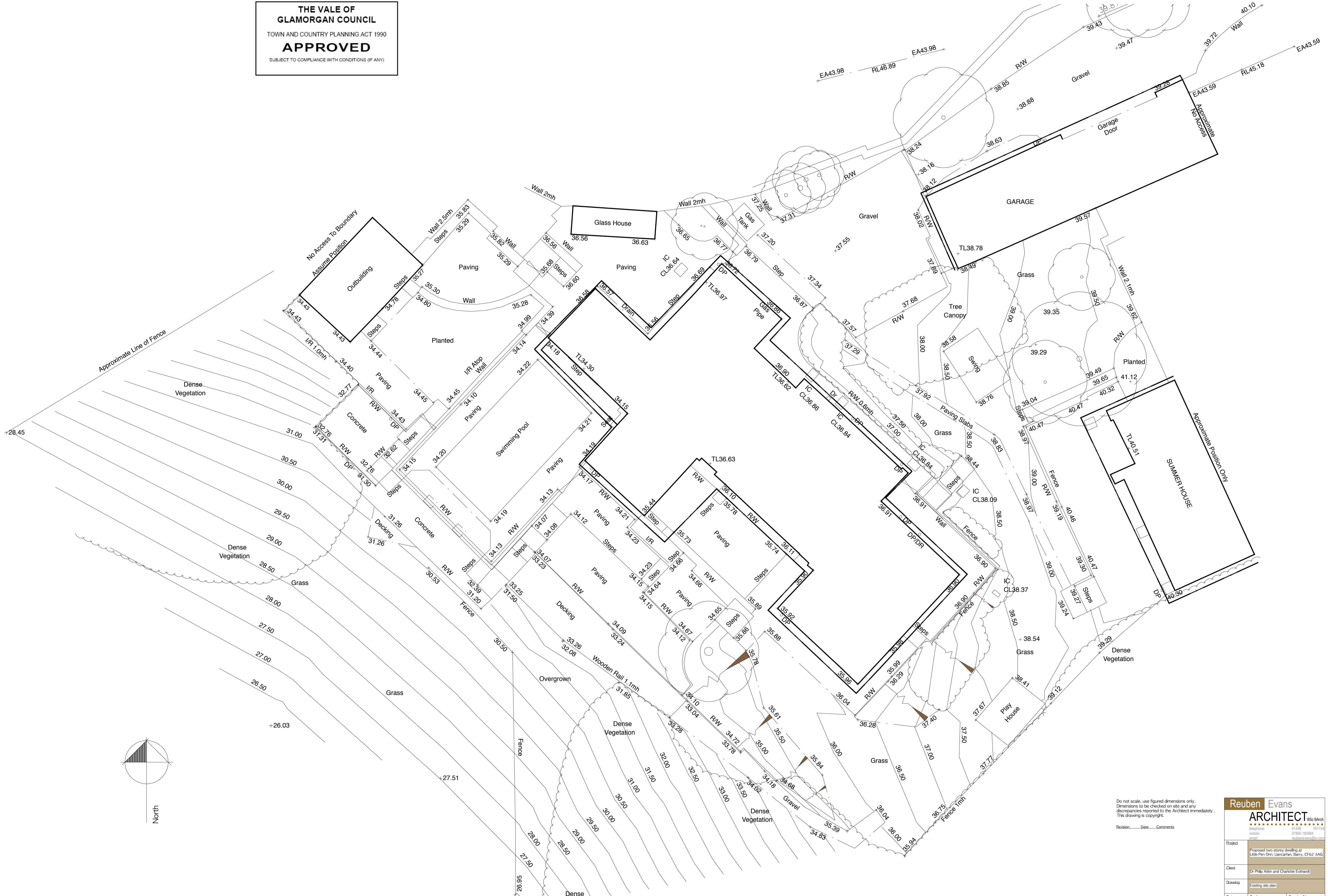

Do not scale, use figured dimensions only. Dimensions to be checked on site and any discrepancies reported to the Architect immediately. This drawing is copyright.

Revision Date Comments

Reuben Evans ARCHITECT BSc BA(Hon)

Telephone: 01446 751154
Mobile: 07890 165884
Email: reubenevans@re.com

Project: Proposed two storey dwelling at Llate Pen Cwm, Llancarfan, Barry, CF62 3AG

Client: Dr Philip Aikin and Charlotte Eckhardt

Drawing: Existing site plan

Date: July 2014
Scale: 1 to 50 at A1
Drawing No.: 132 - 108

PLANNING ISSUE