

THE VALE OF  
GLAMORGAN COUNCIL  
TOWN AND COUNTRY PLANNING ACT 1990  
**APPROVED**  
SUBJECT TO COMPLIANCE WITH CONDITIONS (IF ANY)

Date	Drawn	Check	Description

Rev.:

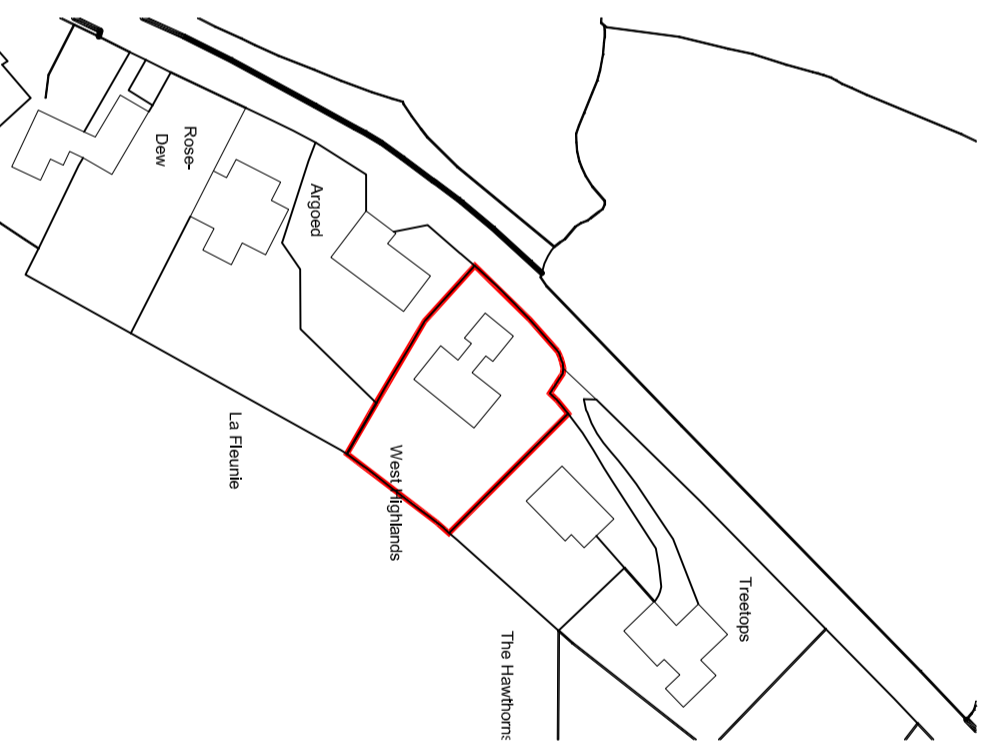
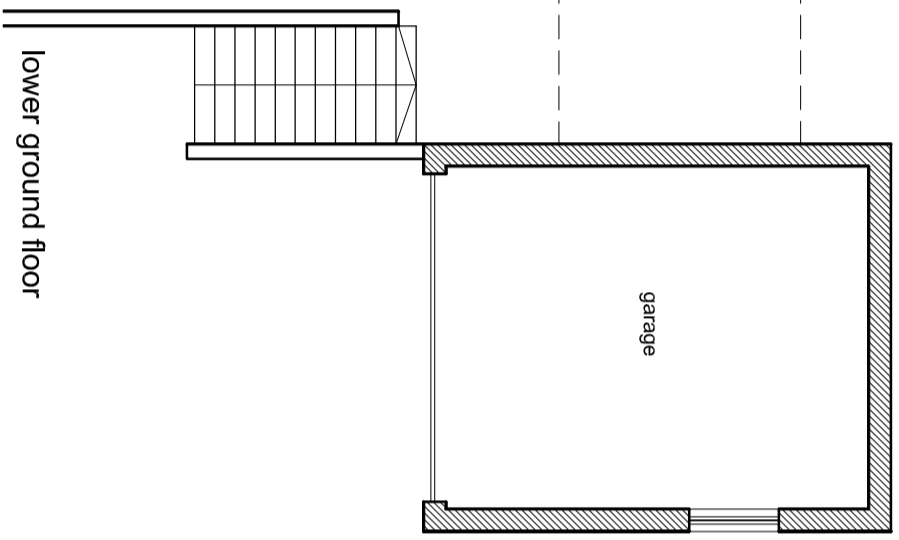

site location @ 1:1250@A3

Job No.	14_009
Dwg No.	AL(0)01
Rev.	A
<b>Proposed Extension</b>	
West Highland	
Craig Penllyn	
Existing Plans	
Date	01/04/14
Drawn	
Scale	1:100/1250 @ A3

Architects Environmental & Urban design

Town planners

Unit 1A, Central Business Park, Rhydifeirdd, Cardiff, CF24 5HT. Tel: 0303 2045100