

THE VALE OF
GLAMORGAN COUNCIL
TOWN AND COUNTRY PLANNING ACT 1990
APPROVED
SUBJECT TO COMPLIANCE WITH CONDITIONS (IF ANY)

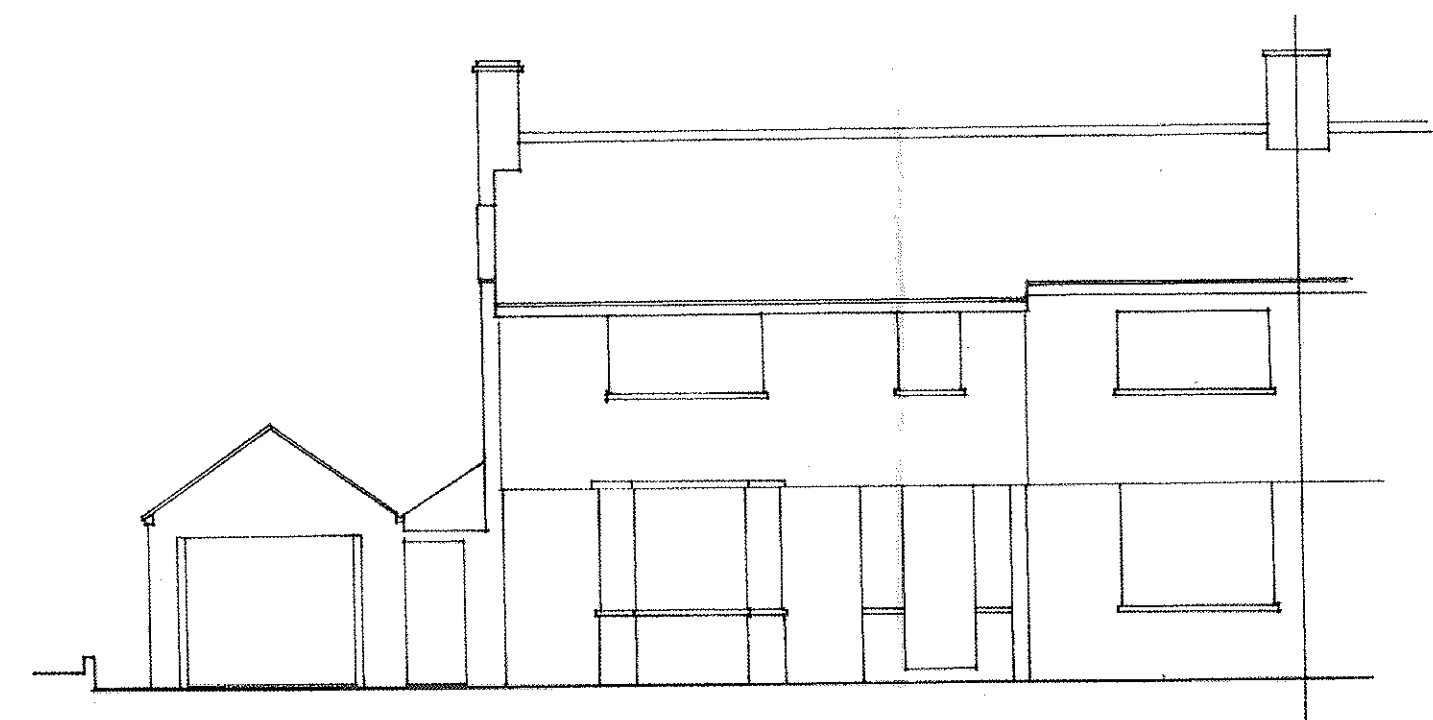

front elevation (existing)

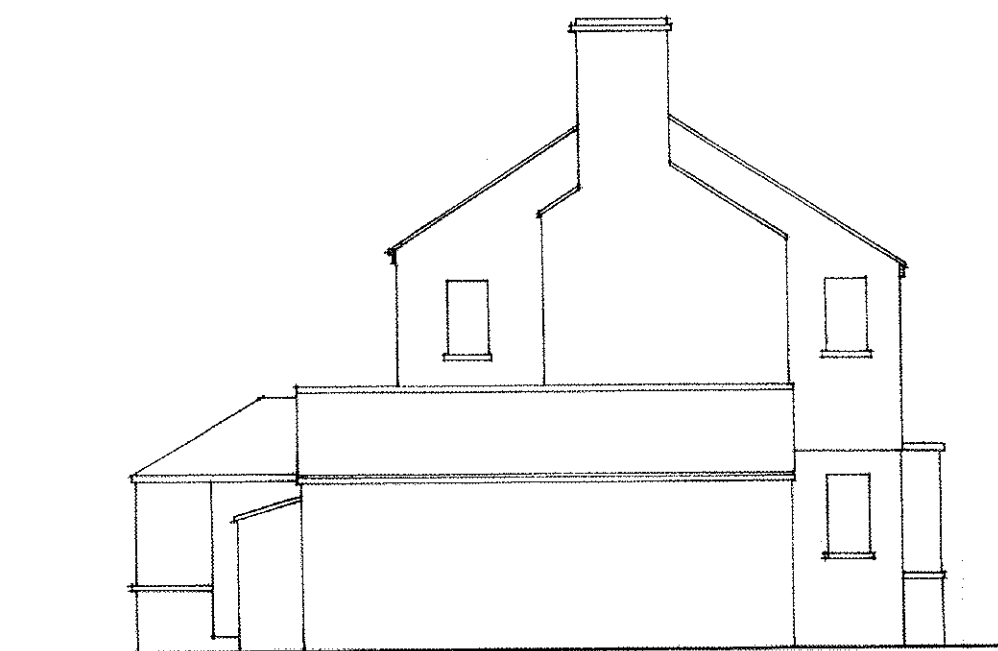

side elevation (existing)

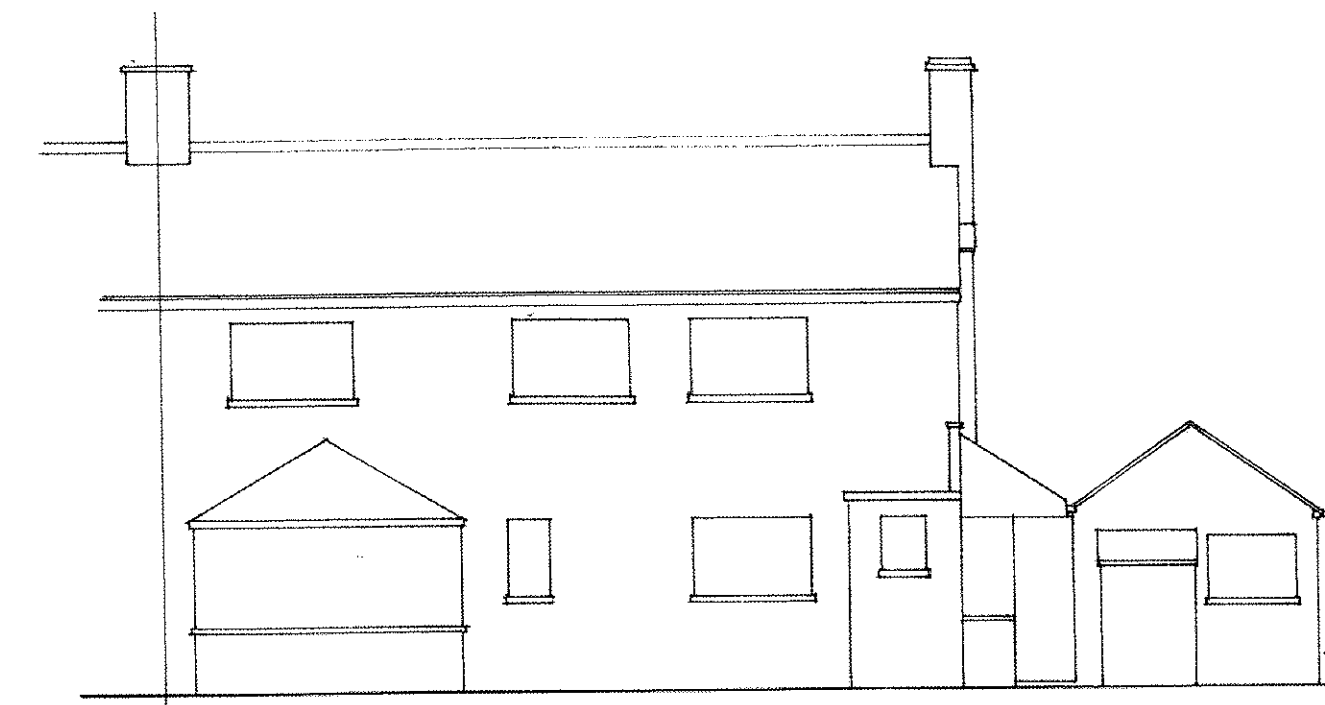

rear elevation (existing)

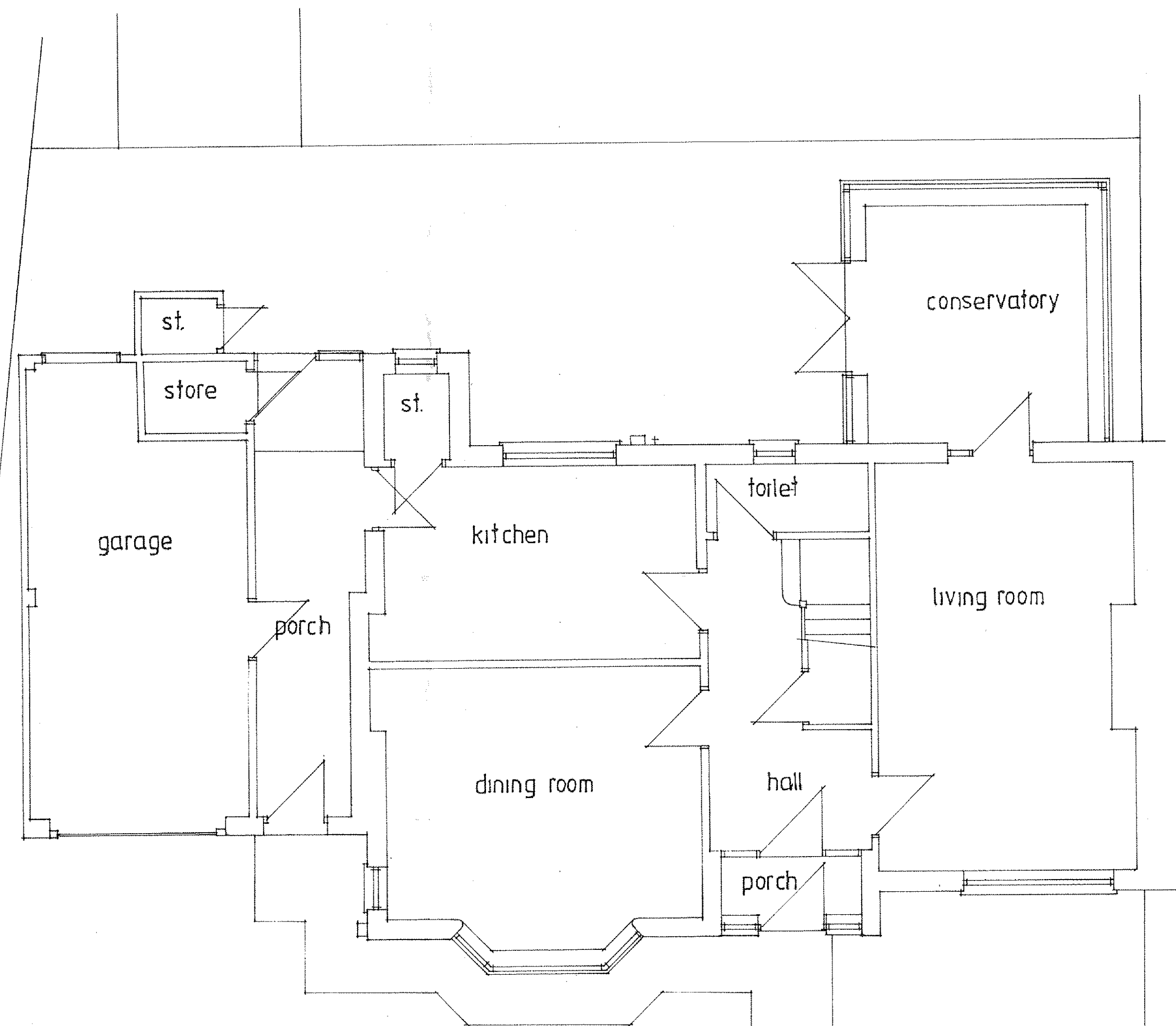

ground floor plan (existing)

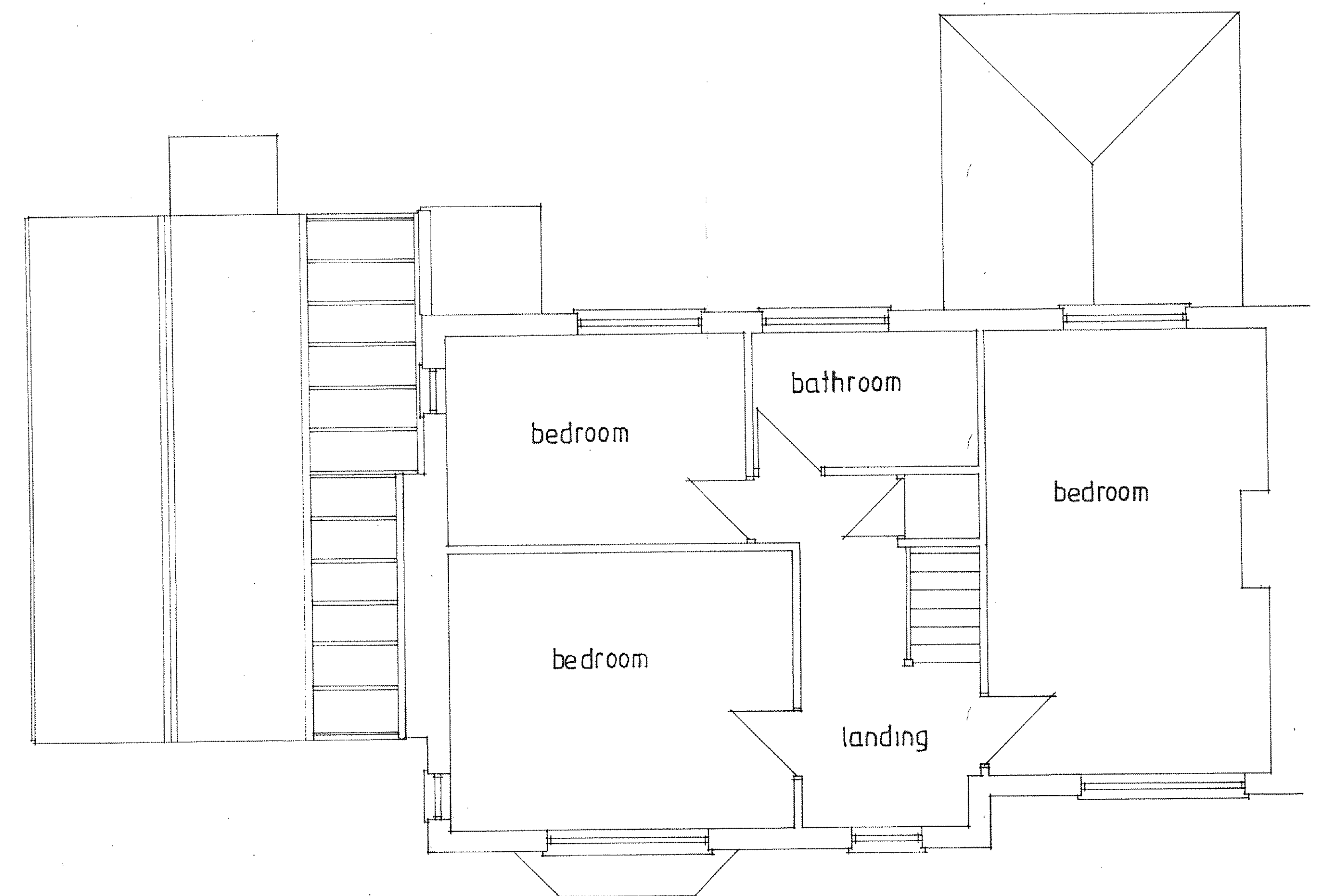

first floor plan (existing)

proposed development at no.28, Trem y Don, Barry

scale 1:100 & 1:50

notes
this drawing is for planning purposes only
all dimensions to be checked on site

RECEIVED

24 JUL 2004

ENVIRONMENTAL
AND ECONOMIC
REGENERATION

1400895 FUL