

THE VALE OF  
GLAMORGAN COUNCIL  
TOWN AND COUNTRY PLANNING ACT 1990  
**APPROVED**  
SUBJECT TO COMPLIANCE WITH CONDITIONS (IF ANY)

14-00839 LAW

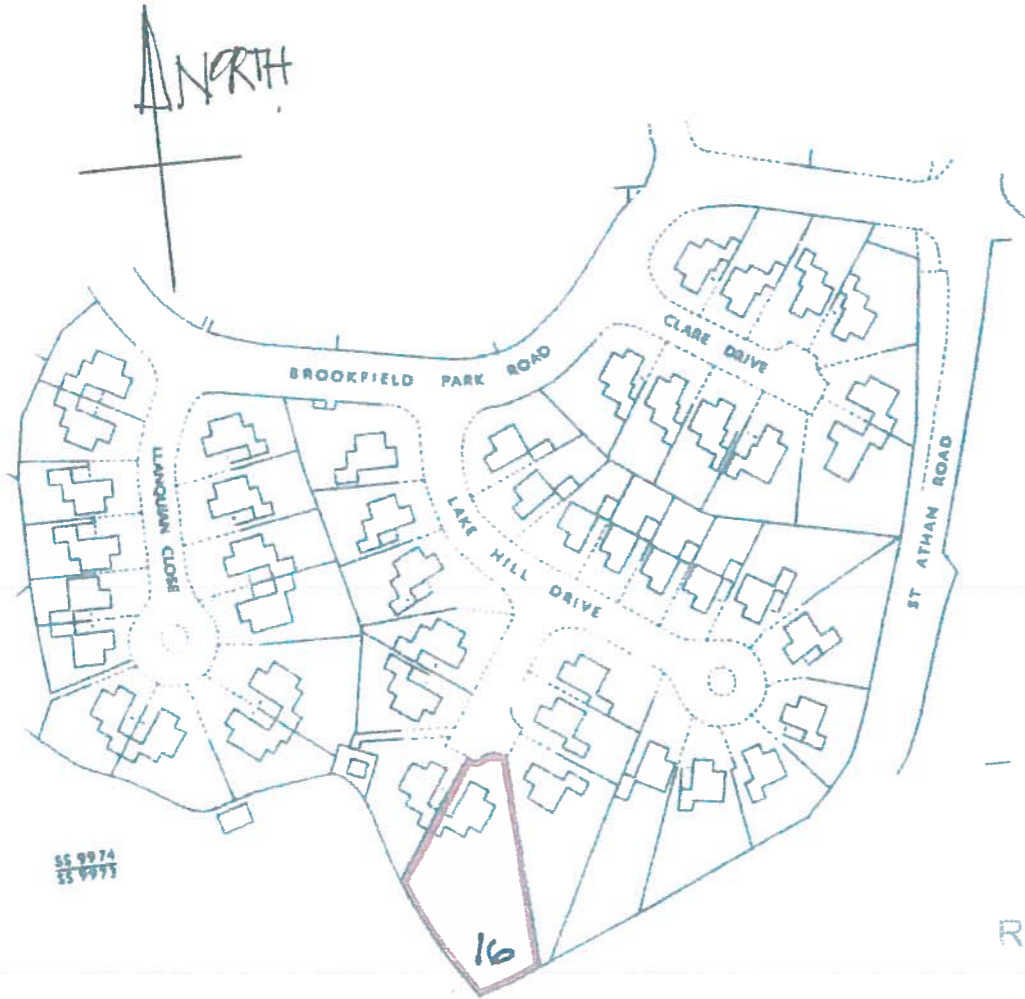

RECEIVED

14 JUL 2014

ENVIRONMENTAL  
AND ECONOMIC  
REGENERATION

Project: **TWO STOREY EXTENSION  
16 LAKE HILL DRIVE,  
COWBRIDGE, Vale of Glam.**

Title **LOCATION PLAN**

Date: July, 2014. Drawn KEW Scale 1:1250

Drawing No. **1396/ BR06**

**KEW** Architectural & Structural Design.  
28 Parcau Avenue, BRIDGEND. CF31 4SY.  
Tel: 01656 667365. E-mail: [kewad01@aol.co.uk](mailto:kewad01@aol.co.uk)