

THE VALE OF
 GLAMORGAN COUNCIL
 TOWN AND COUNTRY PLANNING ACT 1990
APPROVED
 SUBJECT TO COMPLIANCE WITH CONDITIONS (IF ANY)

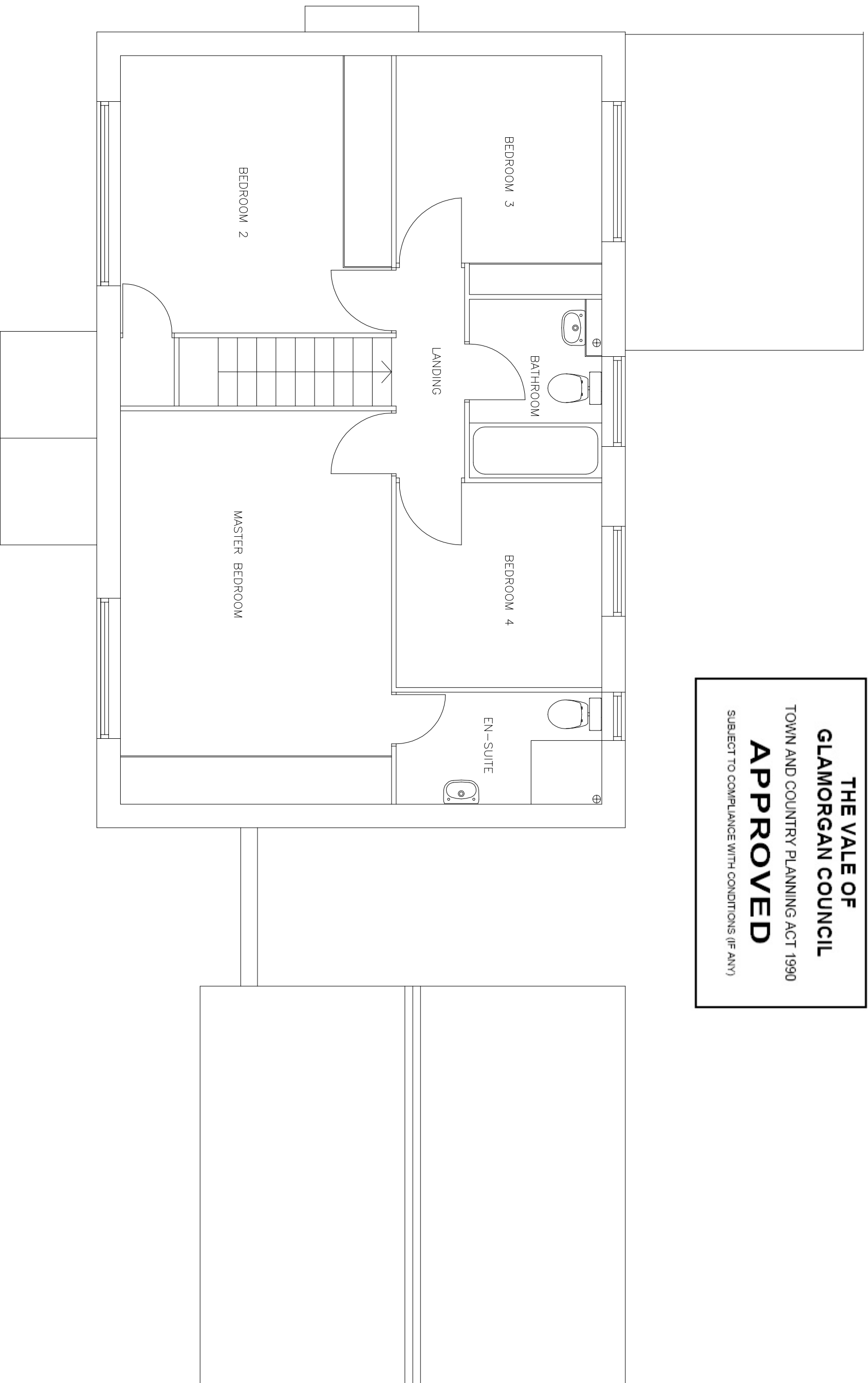

EXISTING FIRST FLOOR PLAN

No	Revision Description	Date	By

CLIENT :
 MR & MRS T DANTER

PROJECT :
 24 WHITCLIFFE DRIVE
 PENARTH

TITLE :
 EXISTING FIRST FLOOR PLAN

Drawn : SS **Date :** 04/2014 **Checked by :** SS

Scale : 1:50 **Original sheet size :** A3

Drawing Status

Design Development

Tender

Design Development-Pre-Construction

Construction

Record

Project No 10380 **Dwg No** 1001 **Rev**



TY CERN, RECTORY ROAD
 CANTON, CARBOR CF5 1JL
 TEL : 029 20 544 966
 FAX : 029 20 544 942
 epi@epipartnership.com
 www.epipartnership.com