

VALE OF GLAMORGAN
COUNCIL
AMENDED PLANS
RECEIVED Date.....

2014/00804/FUL
Received 21 July 2014

THE VALE OF
GLAMORGAN COUNCIL
TOWN AND COUNTRY PLANNING ACT 1990
APPROVED
SUBJECT TO COMPLIANCE WITH CONDITIONS (IF ANY)

NOTES:

This drawing is copyright. It is sent to you in confidence and must not be reproduced or disclosed to third parties without our prior permission.

Do not scale from this drawing.

This drawing is to be read in conjunction with all relevant consultants, specialist manufacturer drawings and specifications.

Any discrepancies in dimensions or details on or between these drawings should be noted and attention.

All dimensions are in millimetres unless noted otherwise.

Any surveyed information incorporated within this drawing cannot be guaranteed as to accuracy unless confirmed by fixed dimension.

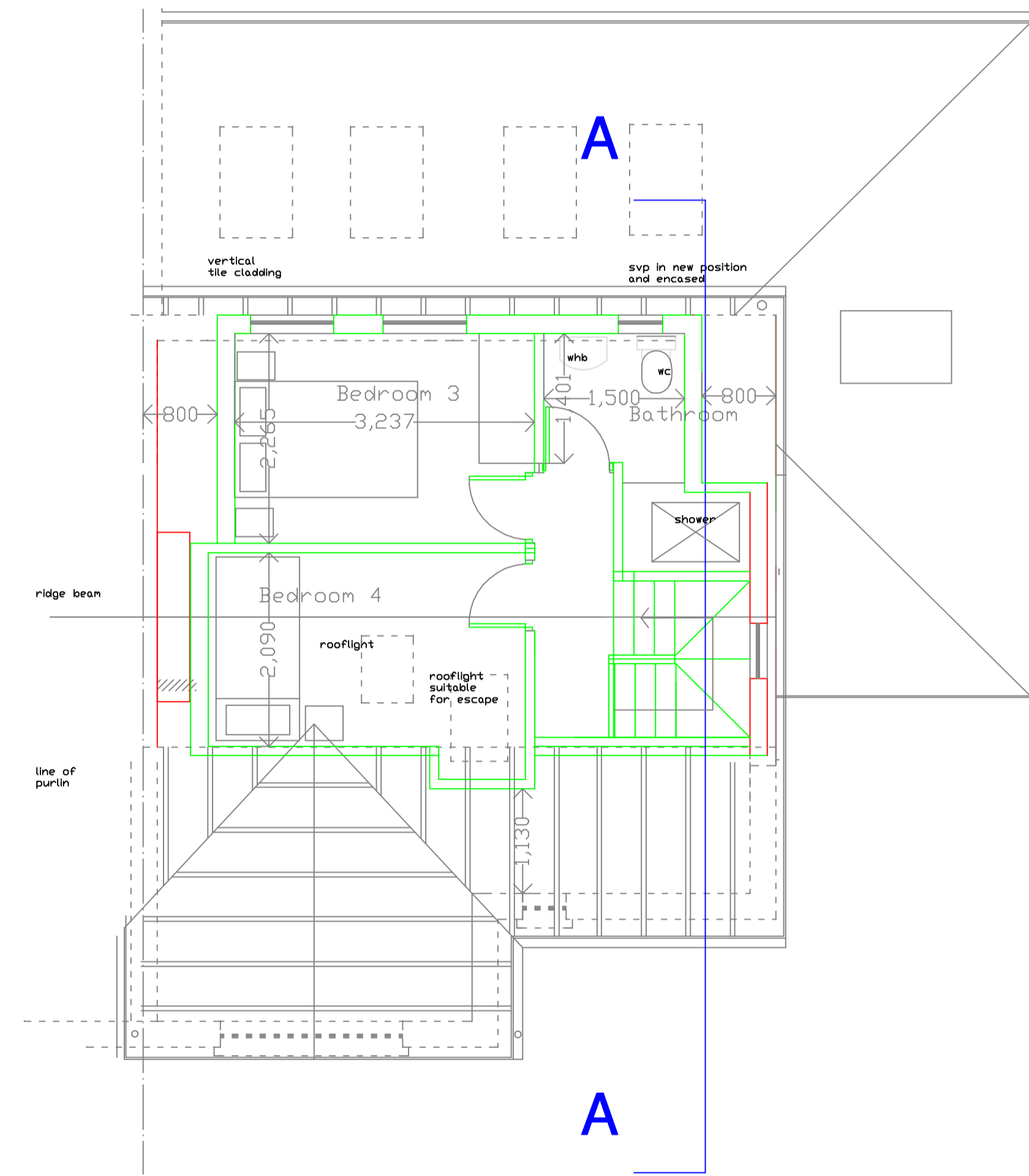

Proposed Plan at Roof Level

REV	DATE	DESCRIPTION

ROSSER ASSOCIATES
20, DUFFRYN RD.,
CYNCOED, CARDIFF.

Tel: 029 20754296

CLIENT **Helen McKechnie/Angela Joyee**
PROJECT **24, St. Davids Crescent,
Penarth**

TITLE **Plan Layouts Updated Scheme**

DATE **16.06.14** PROJECT NO. **SK06**
DRAWN **SR.** CHECKED
SCALE **1:50**