

**GENERAL NOTES:-**

The Contractor is to check and verify all building and site dimensions, levels and sewer invert levels at connection points before work starts. Any discrepancy is to be reported to Healer Associates before work commences.

The Contractor is to comply in all respects with current building legislation - Building Standard Specifications, Building Regulations etc., whether or not specifically stated on this drawing. The drawing must be read with and checked against any structural, geotechnical or other specialist documentation provided.

This drawing is not intended to show details of foundations, ground conditions or ground contaminants. Each area of ground relied upon to support any structure depicted (including drainage) must be investigated by the Contractor. A suitable method of foundation should be provided allowing for all existing ground conditions. Any suspect or fluid ground, contaminants on or within the ground, should be further investigated by a suitable expert. Any earthwork construction shown indicates typical slopes for guidance only and should be further investigated by a suitable expert.

Where existing trees are shown to be retained they should be subject to a full Arboricultural Inspection for safety.

All trees are to be planted so as to ensure they are a minimum of 5 metres from buildings and 6 metres from drainage and services. A suitable method of foundation is to be provided to accommodate the proposed tree planting.

This drawing is copyright, its use or reproduction without written permission of Healer Associates is prohibited.

All sewers which are to be the subject of a Section 104 Agreement are to be constructed in accordance with the National Water Council's Sewers for Adoption document Sixth Edition, and to the satisfaction of the adopting sewerage undertaker.

All the sewer trenches allied within proposed roads are to be back-filled with stone, unless specific written approval is sought and received from the Local Authority's Engineer to return excavated material. Where road levels dictate, the material employed as fill is to be approved by the Local Authority's Engineer.

All adoptable pipes of 225mm diameter or less are to be E.S.V.C. Larger pipes are to be Class H concrete. U.P.V.C. pipes may be used subject to manufacturers recommendations and specific approval of the adopting sewerage undertaker.

All lateral connections to main foul and storm sewers shall be 1500 minimum.

All sewers are to be constructed using Class S granular bed and surround.

All sewers with less than 1.2m of cover beneath roads or 0.9m elsewhere areas to have 150mm thick Class Z concrete bed and surround.

All outfall levels and existing sewer levels are to be confirmed by the Contractor before works commence.

The existing ground levels along the route of the proposed road are to be confirmed by the Contractor before works commence.

All roads which are to be the subject of a Section 38 Agreement are to be constructed in accordance with the Local Highway Authority's current specification and to the satisfaction of the Local Highway Authority's Engineer.

All construction methods and materials employed are to be in accordance with the current road and bridge works specification. All construction thicknesses are to be confirmed by C.B.R. test.

No responsibility will be taken for any construction work undertaken prior to receipt of technical approvals for the intended construction, or when work is not executed strictly in accordance with the drawings.

**NOTES**

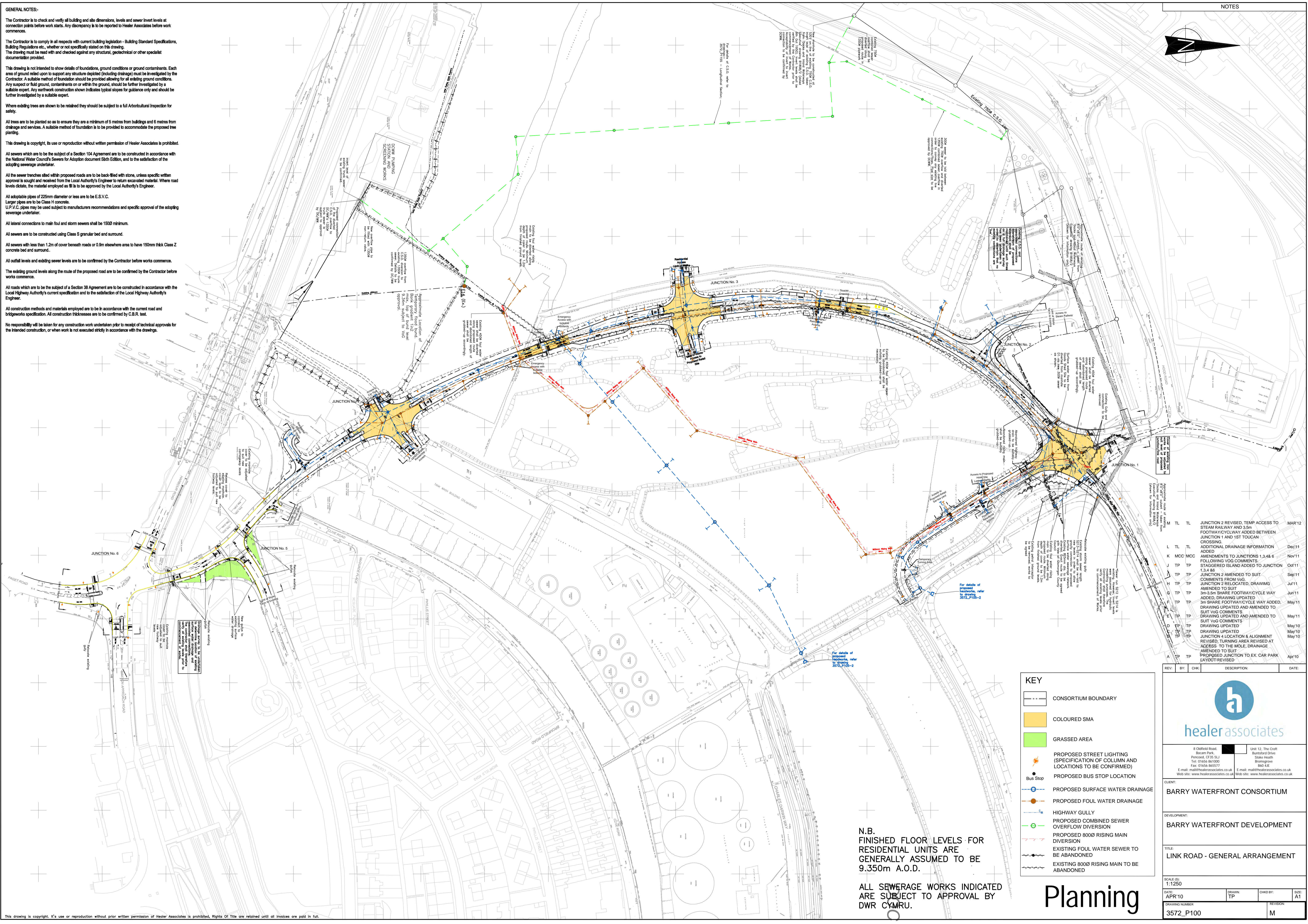
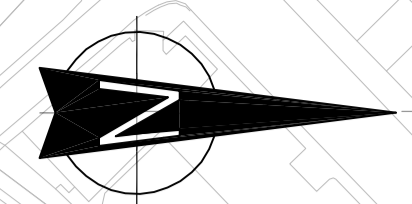

REV	BY	CHK	DESCRIPTION	DATE
M	TL	TL	JUNCTION 2 REVISED, TEMP ACCESS TO STEAM RAILWAY AND 3.5m FOOTWAY/CYCLEWAY ADDED BETWEEN JUNCTION 1 AND 1ST TOUCAN CROSSING.	MAR'12
L	TL	TL	ADDITIONAL DRAINAGE INFORMATION ADDED	Dec'11
K	MCC	MCC	AMENDMENTS TO JUNCTIONS 1,3,4&6 FOLLOWING VOG COMMENTS	Nov'11
J	TP	TP	STAGGERED ISLAND ADDED TO JUNCTION 1,3,4 & 6	Oct'11
I	TP	TP	JUNCTION 2 AMENDED TO SUIT COMMENTS FROM VOG	Sep'11
H	TP	TP	JUNCTION 2 RELOCATED, DRAWING AMENDED TO SUIT	Jul'11
G	TP	TP	3m-3.5m SHARE FOOTWAY/CYCLE WAY ADDED	Jun'11
F	TP	TP	3m SHARE FOOTWAY/CYCLE WAY ADDED. DRAWING UPDATED AND AMENDED TO SUIT VOG COMMENTS	May'11
E	TP	TP	DRAWING UPDATED AND AMENDED TO SUIT VOG COMMENTS	May'11
D	TP	TP	DRAWING UPDATED	May'10
C	TP	TP	JUNCTION 4 LOCATION & ALIGNMENT REVISED, TURNING AREA REVISED AT ACCESS TO THE MOLE, DRAINAGE AMENDED TO SUIT	May'10
A	TP	TP	PROPOSED JUNCTION TO EX. CAR PARK LAYOUT REVISED	Apr'10

**KEY**

- CONSORTIUM BOUNDARY
- COLOURED SMA
- GRASSED AREA
- PROPOSED STREET LIGHTING (SPECIFICATION OF COLUMN AND LOCATIONS TO BE CONFIRMED)
- PROPOSED BUS STOP LOCATION
- PROPOSED SURFACE WATER DRAINAGE
- PROPOSED FOUL WATER DRAINAGE
- HIGHWAY GULLY
- PROPOSED COMBINED SEWER OVERFLOW DIVERSION
- PROPOSED 800Ø RISING MAIN DIVERSION
- EXISTING FOUL WATER SEWER TO BE ABANDONED
- EXISTING 800Ø RISING MAIN TO BE ABANDONED

**N.B.**  
FINISHED FLOOR LEVELS FOR RESIDENTIAL UNITS ARE GENERALLY ASSUMED TO BE 9.350m A.O.D.

**ALL SEWERAGE WORKS INDICATED ARE SUBJECT TO APPROVAL BY DWR CYMRU.**

**healer associates**

8 Oxford Road, Broom Park, Pwllheli, Gwynedd, LL57 2JL  
 Phone: 01752 34111  
 Fax: 01752 34112  
 E-mail: info@healerassociates.co.uk  
 Web site: www.healerassociates.co.uk

---

CLIENT: **BARRY WATERFRONT CONSORTIUM**

---

DEVELOPMENT: **BARRY WATERFRONT DEVELOPMENT**

---

TITLE: **LINK ROAD - GENERAL ARRANGEMENT**

---

SCALE: 1:1250

DATE: APR'10	DRAWN: TP	CHKD BY:	SIZE: A1
DRAWING NUMBER: 3572_P100	REVISION: M		

**Planning**



NOTES

KEY	
	CONSORTIUM BOUNDARY
	COLOURED SMA
	GRASSED AREA
	PROPOSED STREET LIGHTING (SPECIFICATION OF COLUMN AND LOCATIONS TO BE CONFIRMED)
	PROPOSED BUS STOP LOCATION

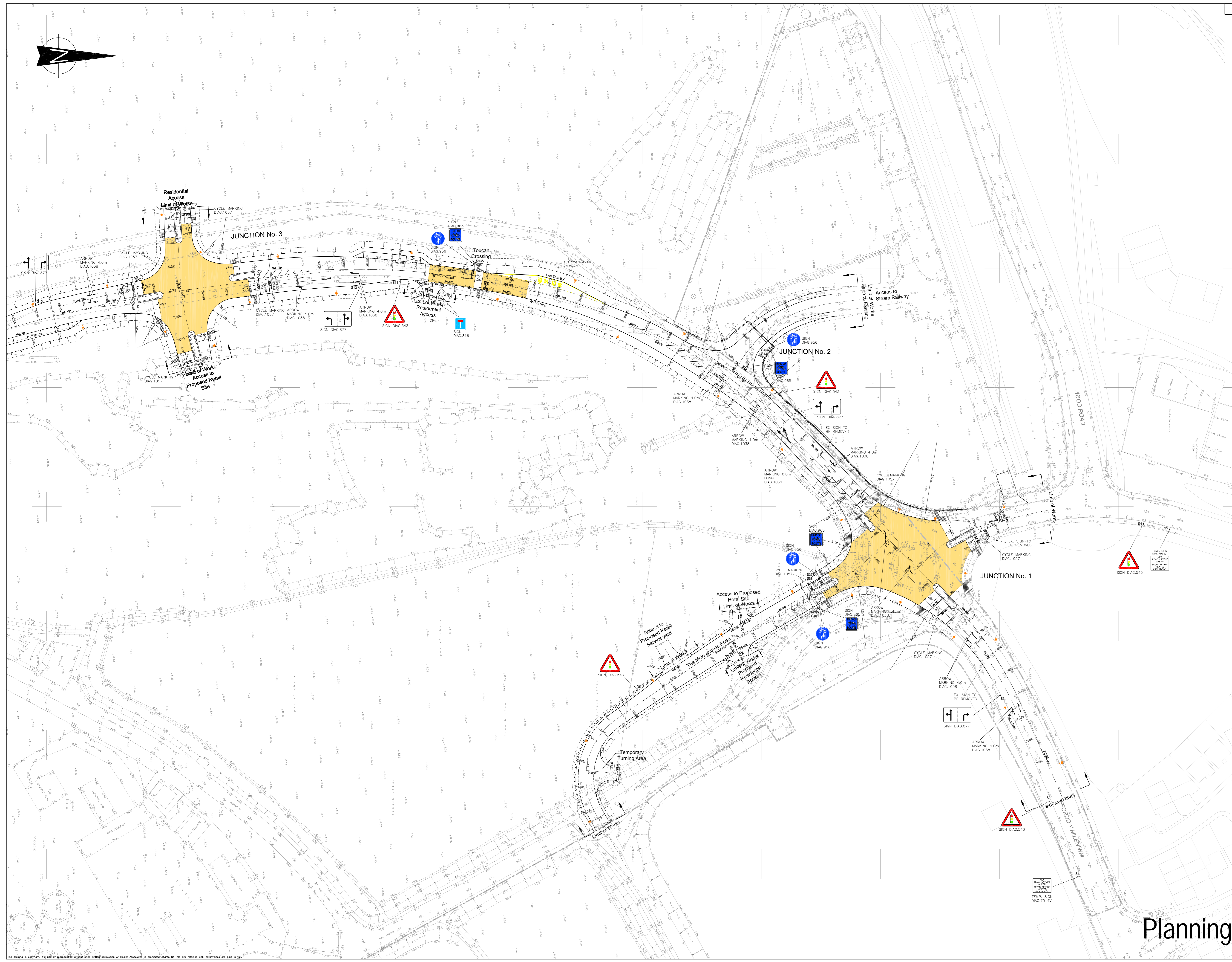

M	TL	TL	JUNCTION 2 REVISED, TEMP ACCESS TO STEAM RAILWAY AND 30m FOOTWAY CYCLEWAY ADDED BETWEEN JUNCTION 1 AND 1ST TOUCAN CROSSING	MAR12
L	TL	TL	STAGGERED ISLANDS ADDED FOR CLARITY - SEE DRAWING P1021 TO 3	Dec11
K	MCC	MCC	AMENDMENTS TO JUNCTIONS 1, 2 & 3 FOLLOWING VOG COMMENTS	Nov11
J	TP	TP	STAGGERED ISLANDS ADDED TO JUNCTION 3, 3.46 COMMENTS	Oct11
I	TP	TP	JUNCTION 2 AMENDED TO SUIT VOG COMMENTS	Sep11
H	TP	TP	JUNCTION 2 RELOCATED, DRAWING AMENDED TO SUIT	Jun11
G	TP	TP	3m SHARE FOOTWAY CYCLEWAY ADDED, DRAWING UPDATED AND AMENDED TO SUIT VOG COMMENTS	Jun11
F	TP	TP	3m SHARE FOOTWAY CYCLEWAY ADDED, DRAWING UPDATED AND AMENDED TO SUIT VOG COMMENTS	May11
E	TP	TP	DRAWING UPDATED & AMENDED TO SUIT VOG COMMENTS	May11
D	TP	TP	DRAWING UPDATED	May10
C	TP	TP	JUNCTION LOCATION ALIGNMENT REVISED, TURNING AREA REVISED AT ACCESS TO THE WALK, DRAINAGE AMENDED TO SUIT	May10
B	TP	TP	PROPOSED JUNCTION TO EX CAR PARK LAYOUT REVISED, DRAINAGE AND SIGNS UPDATED	Apr10

**healer associates**

8 Gifford Road, Broomfield, Essex, SSO 1JF  
 Tel: 01206 860000 Fax: 01206 860177  
 E-mail: mail@healerassociates.co.uk Web site: www.healerassociates.co.uk

Unit 12, The Croft, Broomfield Drive, SSO 1JF  
 Tel: 01206 860177 Fax: 01206 860177  
 E-mail: info@healerassociates.co.uk Web site: www.healerassociates.co.uk

CLIENT: BARRY WATERFRONT CONSORTIUM			
DEVELOPMENT: BARRY WATERFRONT DEVELOPMENT			
TITLE: LINK ROAD - GENERAL ARRANGEMENT			
SHEET 1 OF 2			
SCALE: 1:500	DATE: APR'10	DRAWN: TP	CHECKED BY: M
DRAWING NUMBER: 3572_P1011	REVISION:		

Planning



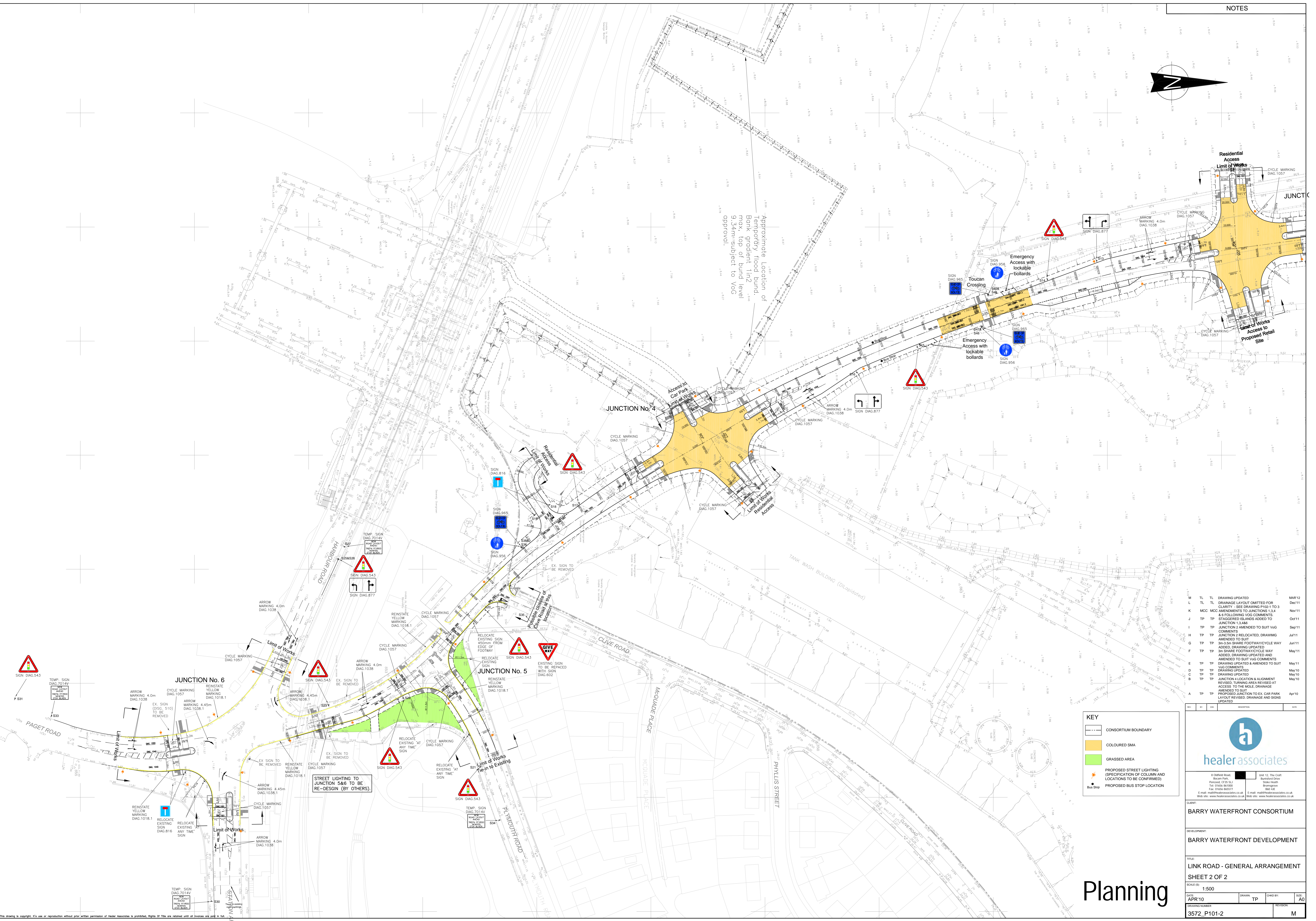
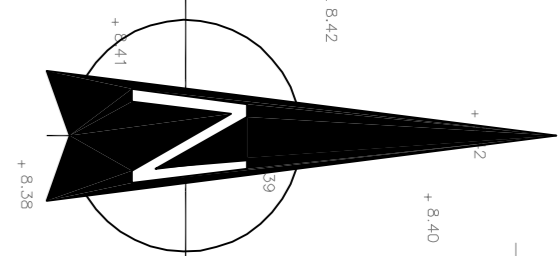

Approximate Location of Temporary flood bund. Bank gradient 1 in 2 max. top of bund level 9.34m - subject to VOG approval.

M	TL	TL	DRAWING UPDATED	MAR'12
L	TL	TL	DRAINAGE LAYOUT OMITTED FOR CLARITY - SEE DRAWING P10-1 TO 3	Dec'11
K	MCC	MCC	AMENDMENTS TO JUNCTIONS 1, 4 & 6 FOLLOWING VOG COMMENTS	Nov'11
J	TP	TP	STAGGERED ISLANDS ADDED TO JUNCTION 1, 3, 4&6	Oct'11
I	TP	TP	JUNCTION 2 AMENDED TO SUIT VOG COMMENTS	Sep'11
H	TP	TP	JUNCTION 2 RELOCATED. DRAWINGS AMENDED TO SUIT	Jul'11
G	TP	TP	3m-3.3m SHARE FOOTWAY/CYCLE WAY ADDED. DRAWING UPDATED	Jun'11
F	TP	TP	3m SHARE FOOTWAY/CYCLE WAY ADDED. DRAWING UPDATED AND AMENDED TO SUIT VOG COMMENTS	May'11
E	TP	TP	DRAWING UPDATED & AMENDED TO SUIT VOG COMMENTS	May'11
D	TP	TP	DRAWING UPDATED	May'10
C	TP	TP	DRAWING UPDATED	May'10
B	TP	TP	JUNCTION LOCATION ALIGNMENT REVISED. TURNING AREA REVISED AT ACCESS TO THE TABLE DRAINAGE	May'10
A	TP	TP	PROPOSED JUNCTION TO EX. DAB PARK LAYOUT REVISED. DRAINAGE AND SIGNS UPDATED	Apr'10

**KEY**

- CONSORTIUM BOUNDARY
- COLOURED SMA
- GRASSED AREA
- PROPOSED STREET LIGHTING (SPECIFICATION OF COLUMN AND LOCATIONS TO BE CONFIRMED)
- PROPOSED BUS STOP LOCATION



8 Gifford Road, Broomfield, Essex, SSO 1LW  
Phone: 01206 880000  
E-mail: info@healerassociates.co.uk  
Unit 12, The Croft, Broomfield, Essex, SSO 1LW  
Phone: 01206 880000  
E-mail: info@healerassociates.co.uk

CLIENT: BARRY WATERFRONT CONSORTIUM

DEVELOPMENT: BARRY WATERFRONT DEVELOPMENT

TITLE: LINK ROAD - GENERAL ARRANGEMENT  
SHEET 2 OF 2

DATE:	APR'10	DRAWN:	TP	CHKD BY:	MM	ISSUE:	A0
DRAWING NUMBER:	3572_P101-2	REVISION:					M

Planning

This drawing is copyright. It's use or reproduction without prior written permission of Healer Associates is prohibited. Rights of this are retained until it involves any part of it.