

THE VALE OF
GLAMORGAN COUNCIL
TOWN AND COUNTRY PLANNING ACT 1990
APPROVED
SUBJECT TO COMPLIANCE WITH CONDITIONS (IF ANY)
D.R. Thomas
HEAD OF PLANNING AND TRANSPORTATION

Cont...
P12.2

Allotment Gardens

VALE OF GLAMORGAN
COUNCIL

AMENDED PLANS

07/002951/K
RECEIVED Date 19.10.2007

Playground

19 OCT 2007

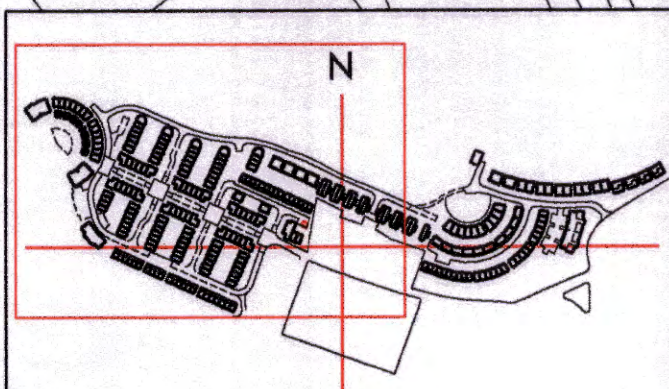

KEY
— Planning Application boundary
— Proposed buildings
— Front gardens
— Rear gardens
PS Proposed pumping station location
ES Proposed electrical substation location
RS Proposed refuse store location
Y Proposed refuse collection point

30 Plot number
30 Carparking space allocated to plot
v1 Carparking space for visitors

REV	DATE	DETAIL
A	18.10.07	Masterplan & site boundary updated.

EDWARD CULLINAN ARCHITECTS LTD
1 BALDWIN TERRACE LONDON N17RU TEL: 020 7704 1975 FAX: 020 7354 2758
email: newprojects@edwardcullinanarchitects.com

PROJECT TITLE
PENARTH HEIGHTS MASTERPLAN

DRAWING TITLE		
SITE LAYOUT: Ground Floor Plan Ridgeway Quarter (1 of 2)		
DATE	SCALE	
08 February 2007	1:500 @A1	
STATUS	DRAWN	CHECKED
PLANNING	WQ	CR
DRAWING NUMBER	REVISION	
P12.1	A	

© EDWARD CULLINAN ARCHITECTS LTD 2006