

THE VALE OF  
GLAMORGAN COUNCIL  
TOWN AND COUNTRY PLANNING ACT 1990  
**APPROVED**  
SUBJECT TO COMPLIANCE WITH CONDITIONS (IF ANY)  
*P. R. Thomas*  
HEAD OF PLANNING AND TRANSPORTATION

NOTES:  
KEY:  
Phase  
spaces for 235 houses 416  
spaces for 142 flats 146  
unallocated 60  
Total  
622

HIGHWAY LAYOUT:  
For highways design details, see latest Gary Gabriel Associates drawings SK101, SK102 & SK103 - Swept Path Analysis For A Refuse Vehicle @1:250

EXTERNAL REALM:  
For open space framework, see latest Nicholas Pearson Associates drawing NPA 10050 206 - Principles of External Realm @1:500

REV DATE DETAIL DRN CHK  
A 18/10/07 Parking numbers amended & increased from 579 to 622 spaces.

VALE OF GLAMORGAN COUNCIL  
AMENDED PLANS  
07/002951PL  
RECEIVED Date 19.10.2007

EDWARD CULLINAN ARCHITECTS LTD  
1 BALDWIN TERRACE, LONDON, N17RU TEL: 020 7794 1975 FAX: 020 7854 2739  
email: newproject@edwardcullinanarchitects.com

PROJECT TITLE  
13 OCT 2007  
PENARTH HEIGHTS MASTERPLAN  
AND ECONOMIC  
REGENERATION

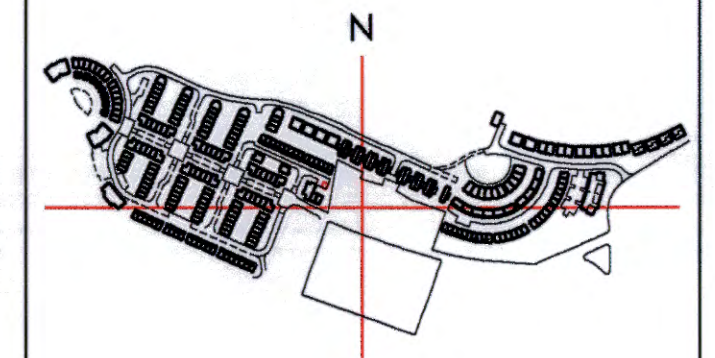

DRAWING TITLE  
SITE LAYOUT  
Proposed Car Parking Provision

DATE  
09 February 2007

SCALE  
1:1000 @A1  
1:2000 @A3

STATUS  
PLANNING

DRAWN  
WQ

CHECKED  
CR

DRAWING NUMBER  
P08

REVISION  
A