

THE VALE OF GLAMORGAN COUNCIL
TOWN AND COUNTRY PLANNING ACT 1990
APPROVED
SUBJECT TO COMPLIANCE WITH CONDITIONS (IF ANY)

VALE OF GLAMORGAN COUNCIL
AMENDED PLANS
2012/00800/OUT
RECEIVED Date 19/9/12

- A 30 06 11 PC Visibility splay amended
- B 01 08 11 PS Site entrance re-positioned
- C 26 04 12 PC 2 bed unit indicated
- D 09 05 12 PC On-site vehicle tracking indicated, site access re-positioned
- E 18 09 12 PC Visibility splay amended

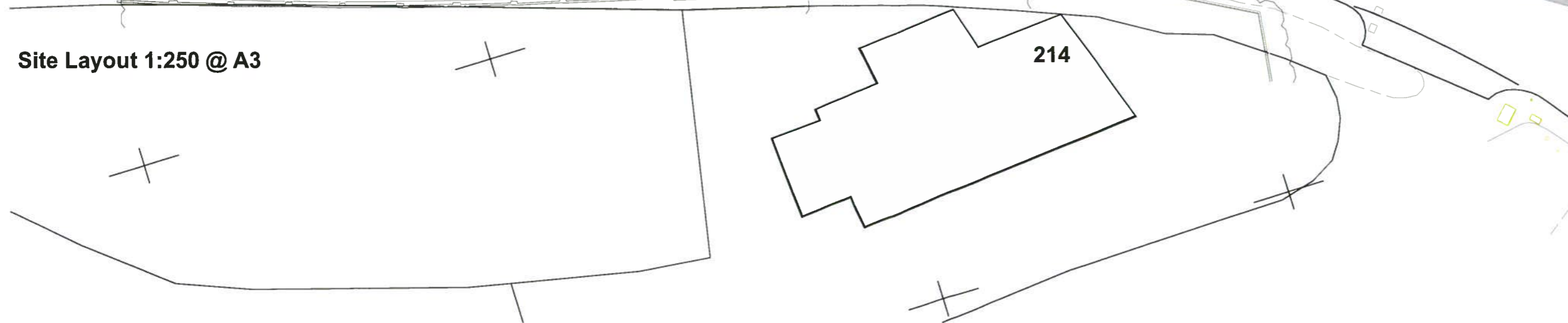
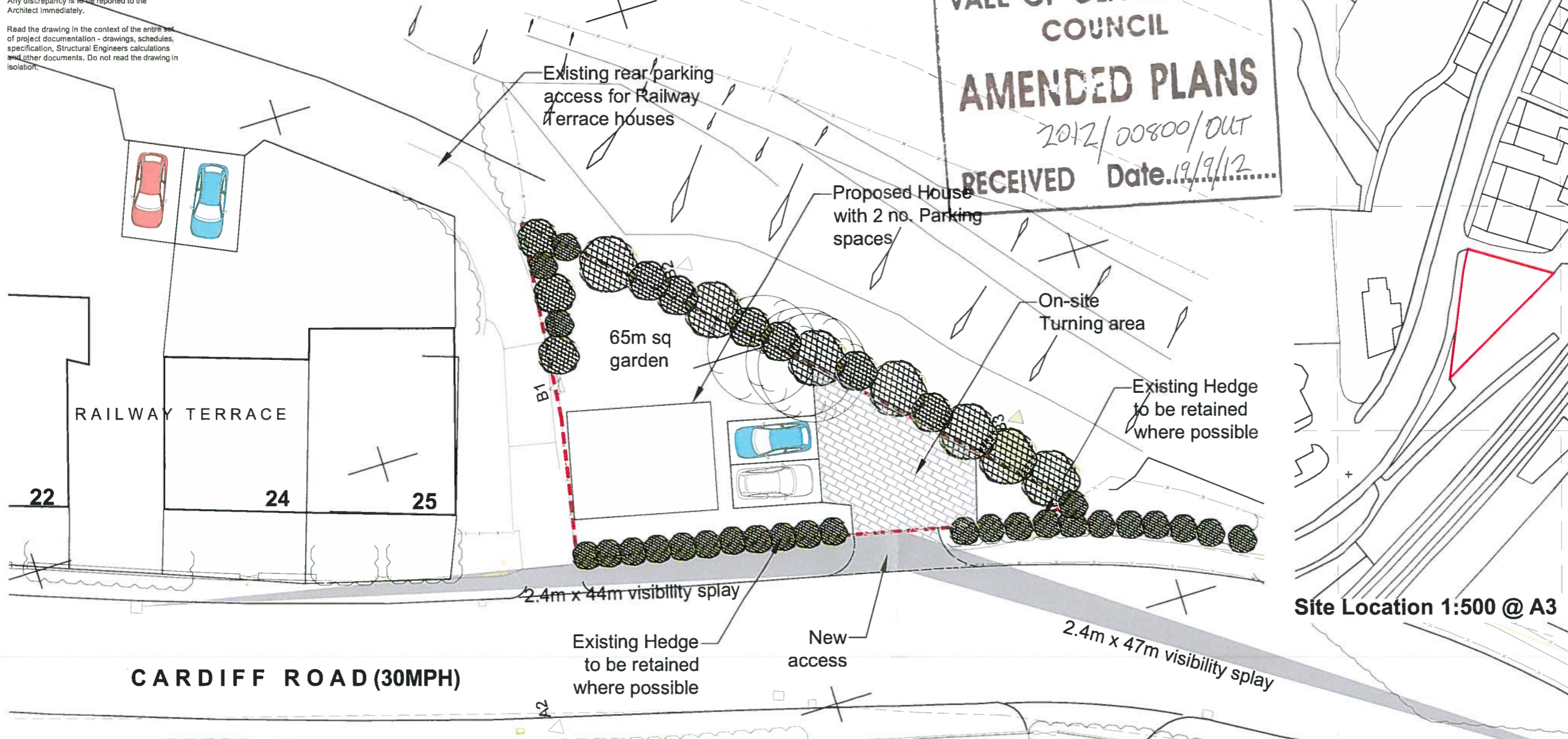

- For Information
- Preliminary
- For Approval
- For Construction
- For Tender
- For Contract
- As Built

PROJECT TITLE
Proposed Dwelling at Railway Terrace off Cardiff Road, Dinas Powys

DRAWING TITLE
Proposed Scheme Layout

SCALE	DRAWN	DATE
As Shown	PC	27 06 11

JOB NO	STAGE	DWG NO	REVISIONS
L000	A	001	E



Tony King Architects Ltd
97a Glebe Street, Penarth
Vale of Glamorgan CF64 1EE

T: 02920 306400
www.tonykingarchitects.co.uk

Dwg No: 001

Proposed Scheme Layout