

**NOTES:**  
 1. ALL DIMENSIONS ARE IN MILLIMETERS UNLESS OTHERWISE STATED.  
 2. ALL LEVELS ARE IN METERS ABOVE GROUND LEVEL.  
 3. DO NOT SCALE FROM THIS DRAWING.

**LEGEND:**

- PLANNING APPLICATION BOUNDARY
- EXISTING
- PROPOSED
- TEMPORARY CONTRACTORS COMPOUND
- PROPOSED SECURITY FENCE TO TIE INTO EXISTING FENCE LINE

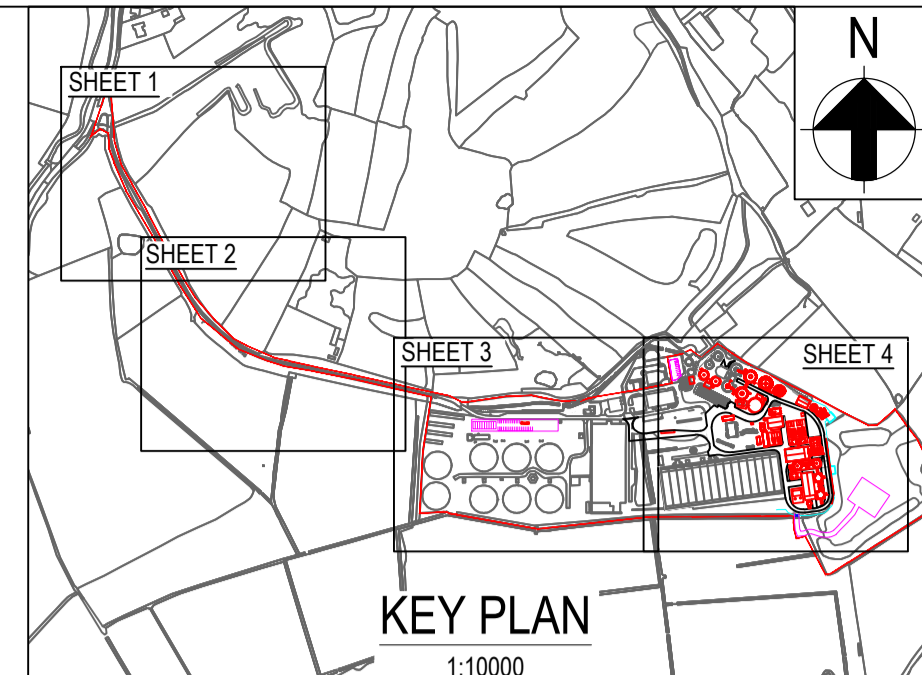

**PROPOSED STRUCTURES**

TAG No.	STRUCTURE NAME	HEIGHT ABOVE GROUND m	MAIN MATERIAL	COLOUR
<b>PROPOSED STRUCTURES</b>				
1A	SAS TANK A	11.337	GLASS COATED STEEL	GOOSE GREY
1B	SAS TANK B	11.337	GLASS COATED STEEL	MIDNIGHT GREEN
3A	PRIMARY STRAINPRESS	12.260	GALVANISED STEEL	GREY
3B	SAS STRAINPRESS	12.110	GALVANISED STEEL	GREY
4A	CENTRIFUGE FEED PUMPS	1.500	MIXED METAL	
4B	CENTRIFUGE FEED TANK	13.173	GLASS COATED STEEL	MIDNIGHT GREEN
4C	CENTRIFUGE FEED TANK	13.173	GLASS COATED STEEL	MIDNIGHT GREEN
5	INDIGENOUS DEWATERING BUILDING	12.708	PROFILED METAL CLADDING	HOLLY GREEN
6	CAKE IMPORTS FACILITY	5.168	MIXED METAL & PROFILED METAL CLADDING	GREY & HOLLY GREEN
7A	THP FEED SILO A	15.385	GLASS COATED STEEL	MIDNIGHT GREEN
7B	THP FEED SILO B	15.385	GLASS COATED STEEL	MIDNIGHT GREEN
8	THP PLANT	8.798	MIXED METAL	GREY
9	COOLING PLANT	3.075	STAINLESS STEEL	GREY
10C	SECONDARY DIGESTER TANK C	12.452	GLASS COATED STEEL & STAINLESS STEEL	MIDNIGHT GREEN & GREY
10D	SECONDARY DIGESTER TANK D	12.452	GLASS COATED STEEL & STAINLESS STEEL	MIDNIGHT GREEN & GREY
11	GAS HOLDER	14.000	PVC COATED POLYESTER FABRIC	WHITE
12	FLARE STACK	8.600	STAINLESS STEEL	GREY
13	SILOXANE PLANT	3.200	MIXED METAL	GREY
14	CHP PLANT	2.769	PAINTED METAL	GREEN
15	BOILER HOUSE	8.000	PROFILED METAL CLADDING	JUNIPER GREEN
16	POST DIGESTION TANK	5.734	CONCRETE	CONCRETE
17	WASH WATER TANK	8.320	GLASS COATED STEEL	MIDNIGHT GREEN
18	FINAL DEWATERING BUILDING	12.708	PROFILED METAL CLADDING	HOLLY GREEN
19	FINAL EFFLUENT HOLDING TANK	12.222	GLASS COATED STEEL	MIDNIGHT GREEN
20	DISINFECTED FE BUILDING	4.978	PROFILED METAL CLADDING	HOLLY GREEN
21	DISINFECTED FE STORAGE TANK	12.534	GLASS COATED STEEL	MIDNIGHT GREEN
22	LIQUOR BALANCE PUMPING STATION	0.250	CONCRETE	CONCRETE
24	TRANSFORMERS	2.858	MIXED METAL	GREY
25A	EXPORT SILO A	14.875	GLASS COATED STEEL	MIDNIGHT GREEN
25B	EXPORT SILO B	14.875	GLASS COATED STEEL	MIDNIGHT GREEN
26A	ODOUR CONTROL UNIT A	5.060	PVC/GRP	HOLLY GREEN
26C	ODOUR CONTROL UNIT C	4.800	PVC/GRP	HOLLY GREEN
29	STACK	18.000	STAINLESS STEEL WITH INSULATED CLADDING	GREY
30A	POLYMER SILOS	6.450	PAINTED MILD STEEL	HOLLY GREEN
31	WEIGHBRIDGE	0.100	MIXED METAL	
32	FE FEED PUMPING STATION	0.250	CONCRETE	CONCRETE
33	MCC1 KIOSK	4.500	GRP	HOLLY GREEN
34	HV SWITCHGEAR BUILDING	6.646	PROFILED METAL CLADDING	HOLLY GREEN
35	LVDB AND MCC3 BUILDING	6.646	PROFILED METAL CLADDING	HOLLY GREEN
51	NATURAL GAS METER KIOSK	2.400	GRP	HOLLY GREEN
52	WASH WATER BOOSTER KIOSK	2.750	GRP	HOLLY GREEN
53	WHEEL WASH CONTROL KIOSK	2.900	GRP	HOLLY GREEN
<b>EXISTING STRUCTURES TO BE DEMOLISHED</b>				
1A	SAS TANK A	7.650	GLASS COATED STEEL	MIDNIGHT GREEN
1B	SAS TANK B	7.650	GLASS COATED STEEL	MIDNIGHT GREEN
10C	SECONDARY DIGESTER TANK C	6.980	GLASS COATED STEEL	MIDNIGHT GREEN
10D	SECONDARY DIGESTER TANK D	6.980	GLASS COATED STEEL	MIDNIGHT GREEN
26A	ODOUR CONTROL UNIT A	4.760	PVC/GRP	GREEN
36	METHANE STORAGE TANK	9.042	PVC COATED POLYESTER FABRIC	WHITE
43	SUPERNATANT TANK	7.230	GLASS COATED STEEL	MIDNIGHT GREEN
44A	OPERATIONAL STORAGE TANK A	7.250	GLASS COATED STEEL	MIDNIGHT GREEN
44B	OPERATIONAL STORAGE TANK B	7.250	GLASS COATED STEEL	MIDNIGHT GREEN

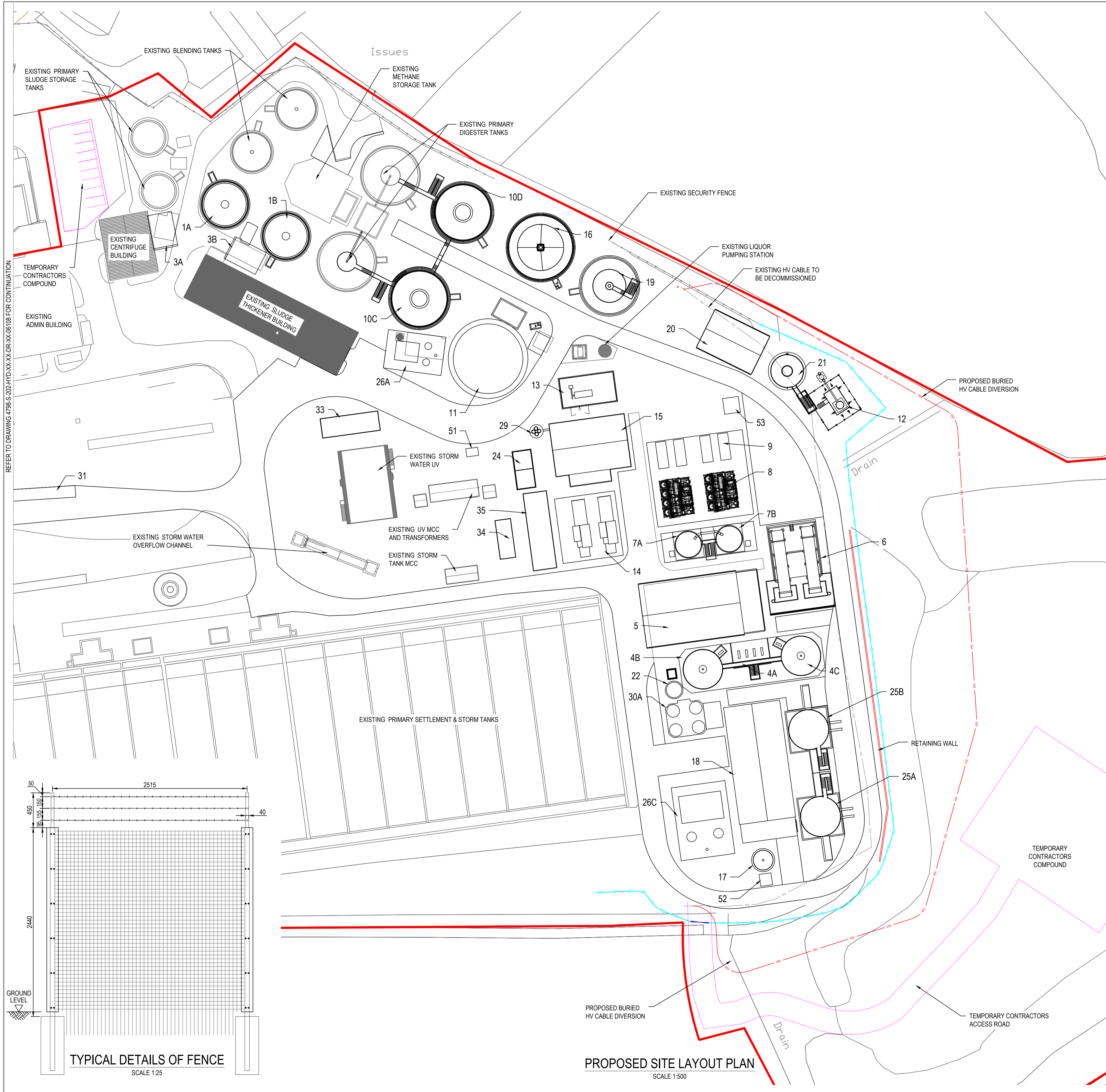

REFER TO DRAWING 4798-S-202-HYD-XX-XX-DR-XX-06108 FOR CONTINUATION

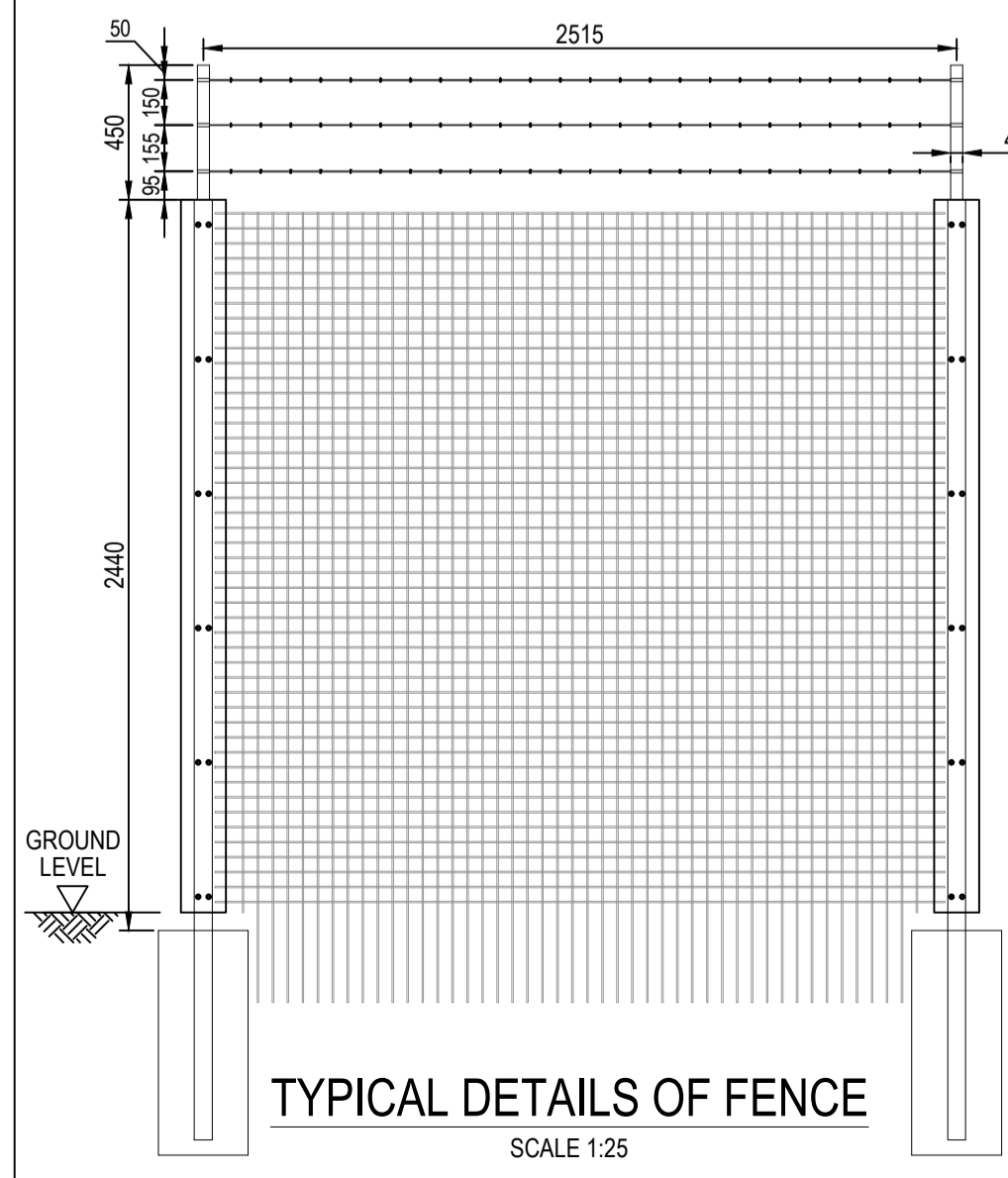

**PROPOSED SITE LAYOUT PLAN**  
SCALE 1:500

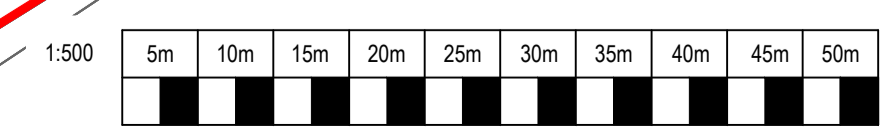

P02	06/11/17	DP	FOR INFORMATION	YF	MN	06/11/17
P01	21/08/17	DP	FOR INFORMATION	YF	MN	21/08/17
Rev.	Date	Drawn	Description	Chkd	Appd	Date
 Cynghair Cyflawni Cyfalf						
Ty Awen, Spooner Close, Coed Kernew, Newport, NP108FZ						
Project Name: COG MOORS WwTW AAD						
Drawing Title: PROPOSED SITE LAYOUT PLAN SHEET 4 OF 4						
Suitability: ISSUED FOR INFORMATION						Suitability Code: S2
Originator: DP	Designer: RN	Date: 06/11/17				
Internal Project Number: UA007902	Scale: 1:500	Rev: P02				
Drawing Number: 4798-S-202-HYD-XX-XX-DR-XX-06109						