

REFER TO DRAWING 4798-S-202-HYD-XX-XX-DR-XX-06 FOR CONTINUATION

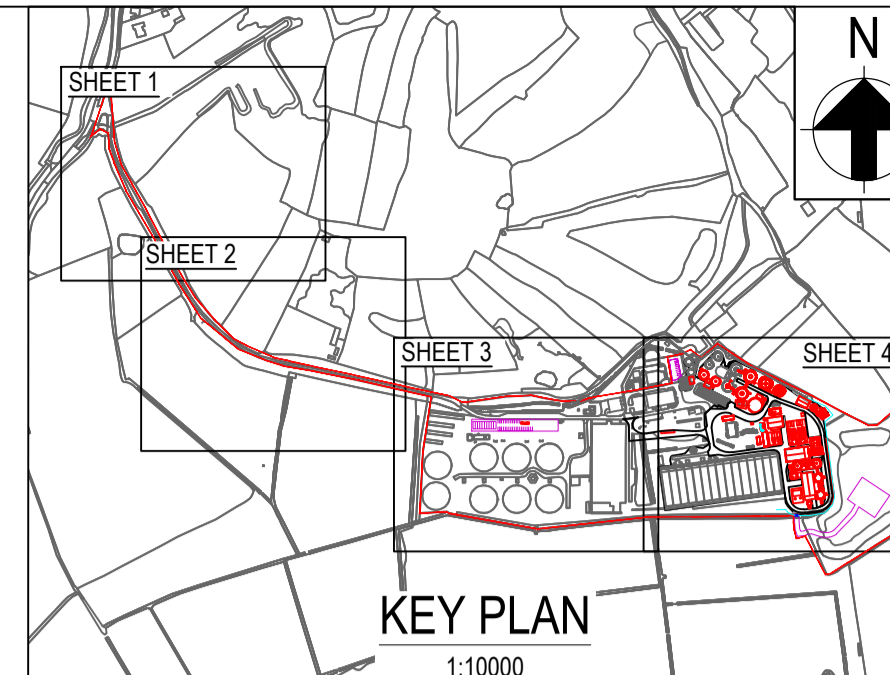

- NOTES:**
1. ALL DIMENSIONS ARE IN MILLIMETERS UNLESS OTHERWISE STATED.
 2. ALL LEVELS ARE IN METERS ABOVE GROUND LEVEL.
 3. DO NOT SCALE FROM THIS DRAWING.
- LEGEND:**
- PLANNING APPLICATION BOUNDARY
 - EXISTING
 - PROPOSED
 - TEMPORARY CONTRACTORS COMPOUND
 - PROPOSED SECURITY FENCE TO TIE INTO EXISTING FENCE LINE

PROPOSED STRUCTURES	
TAG No.	STRUCTURE NAME
PROPOSED STRUCTURES	
1A	SAS TANK A
1B	SAS TANK B
3A	PRIMARY STRAINPRESS
3B	SAS STRAINPRESS
4A	CENTRIFUGE FEED PUMPS
4B	CENTRIFUGE FEED TANK
4C	CENTRIFUGE FEED TANK
5	INDIGENOUS DEWATERING BUILDING
6	CAKE IMPORTS FACILITY
7A	THP FEED SILO A
7B	THP FEED SILO B
8	THP PLANT
9	COOLING PLANT
10C	SECONDARY DIGESTER TANK C
10D	SECONDARY DIGESTER TANK D
11	GAS HOLDER
12	FLARE STACK
13	SILOXANE PLANT
14	CHP PLANT
15	BOILER HOUSE
16	POST DIGESTION TANK
17	WASH WATER TANK
18	FINAL DEWATERING BUILDING
19	FINAL EFFLUENT HOLDING TANK
20	DISINFECTED FE BUILDING
21	DISINFECTED FE STORAGE TANK
22	LIQUOR BALANCE PUMPING STATION
24	TRANSFORMERS
25A	EXPORT SILO A
25B	EXPORT SILO B
26A	ODOUR CONTROL UNIT A
26C	ODOUR CONTROL UNIT C
29	STACK
30A	POLYMER SILOS
31	WEIGHBRIDGE
32	FE FEED PUMPING STATION
33	MCC1 KIOSK
34	HV SWITCHGEAR BUILDING
35	LVDB AND MCC3 BUILDING
51	NATURAL GAS METER KIOSK
52	WASH WATER BOOSTER KIOSK
53	WHEEL WASH CONTROL KIOSK
EXISTING STRUCTURES TO BE DEMOLISHED	
1A	SAS TANK A
1B	SAS TANK B
10C	SECONDARY DIGESTER TANK C
10D	SECONDARY DIGESTER TANK D
26A	ODOUR CONTROL UNIT A
36	METHANE STORAGE TANK
43	SUPERNATANT TANK
44A	OPERATIONAL STORAGE TANK A
44B	OPERATIONAL STORAGE TANK B

REFER TO DRAWING 4798-S-202-HYD-XX-XX-DR-XX-06 FOR CONTINUATION

P02	17/10/17	DP	FOR INFORMATION	YF	MN	17/10/17
P01	21/08/17	DP	FOR INFORMATION	YF	MN	21/08/17
Rev.	Date	Drawn	Description	Chkd	Appd	Date

Capital Delivery Alliance
Cynghair Cyflawni Cyfalaf
 Ty Awon, Spooner Close, Coed Kernew, Newport, NP108FZ

Project Name: **COG MOORS WwTW AAD**

Drawing Title: **PROPOSED SITE LAYOUT PLAN SHEET 2 OF 4**

Suitability: **FOR INFORMATION** Suitability Code: **S2**

Originator: **DP** Designer: **RN** Date: **17/10/17**

Internal Project Number: **UA007902** Scale: **1:500** Rev: **P02**

Drawing Number: **4798-S-202-HYD-XX-XX-DR-XX-06107**

PROPOSED SITE LAYOUT PLAN
SCALE 1:500

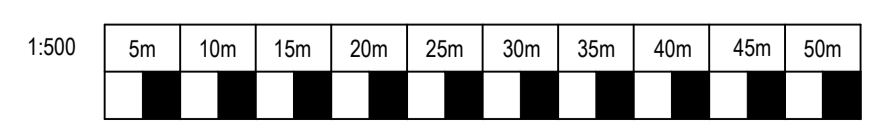

THIS MAP IS BASED UPON THE ORDINANCE SURVEY MATERIAL WITH THE PERMISSION OF ORDINANCE SURVEY ON BEHALF OF THE CONTROLLER OF HER MAJESTY'S STATIONARY OFFICE © CROWN COPYRIGHT 2016. LICENSE NUMBER